

LUBRICATION SCIENTIFICS, LLC

THE RIGHT PRODUCTS. THE RIGHT VALUES. THE RIGHT CHOICE.

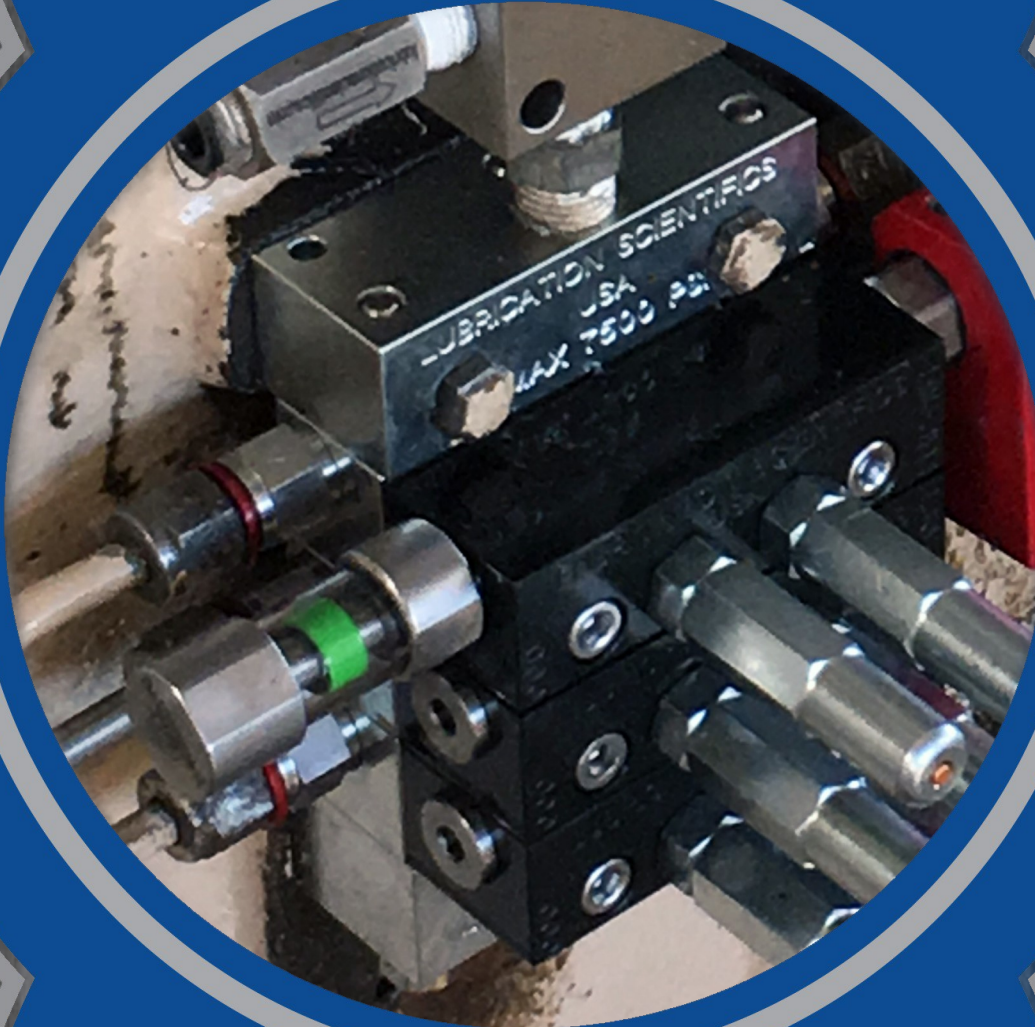

LHP SERIES PROGRESSIVE DIVIDER VALVE SYSTEMS
HIGH PRESSURE VALVES—CRITICAL MONITORING—ACCESSORIES



LHP—HIGH PRESSURE, SERIES PROGRESSIVE DIVIDER VALVE

PRODUCT DESCRIPTION

HIGH PRESSURE, SERIES PROGRESSIVE DIVIDER VALVES

IDEAL FOR GAS ENGINES, COMPRESSORS, AND OTHER ROTATING EQUIPMENT

AVAILABLE IN PLATED CARBON, 303, AND 316 STAINLESS STEEL

DESIGNED WITH FEEDBACK MONITORING SYSTEM PERFORMANCE

INTERNAL CHECK VALVES COME STANDARD KEEPING LUBE LINES FULL

CAN ACCOMMODATE 1-22 LUBE POINTS PER VALVE ASSEMBLY

BENEFITS & FEATURES

PRECISE LUBRICANT FLOW TO EACH LUBE POINT

STANDARD FOOTPRINT, HIGH PRESSURE 7500 PSI

INTERNAL CHECK VALVES (316 SS BALLS & SPRINGS)

CARBON OR STAINLESS STEEL CONSTRUCTION

USED FOR HIGH PRESSURE OIL APPLICATIONS

1-22 LUBE POINTS PER VALVE ASSEMBLY

WIDE RANGE OF ACCESSORIES AVAILABLE FOR ANY SYSTEM REQUIREMENT

READY FOR IMMEDIATE SHIPMENT

MADE IN



WWW.LUBRICATIONSCIENTIFICS.COM

FUNCTION ILLUSTRATION & SPECIFICATIONS

PRECISE LUBRICATION IS ESSENTIAL FOR PROPER MECHANICAL PERFORMANCE. PUMPS PROVIDE MEASURED PRESSURIZED LUBRICATION TO MASTER VALVE. MASTER VALVE DISTRIBUTES A MEASURED AMOUNT OF LUBRICATION TO CORRESPONDING SECONDARY VALVES. SECONDARY VALVES DISTRIBUTE MEASURED LUBRICATION TO VARIOUS LUBE POINTS IN SYSTEM.

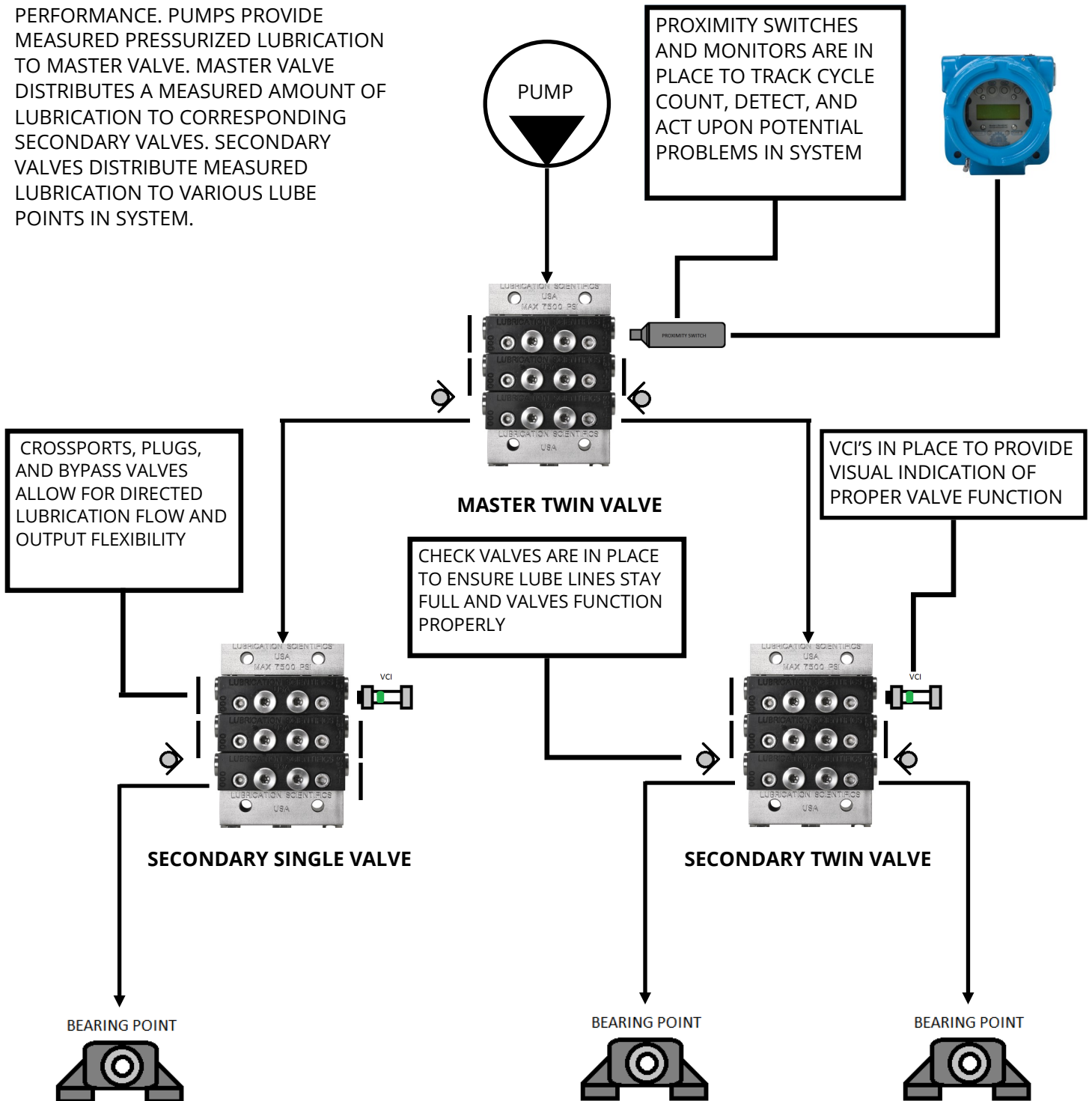

**ORDERING INFORMATION & PART NUMBERS
INLETS, OUTLETS, & ENDS**

MANIFOLD COMPONENTS

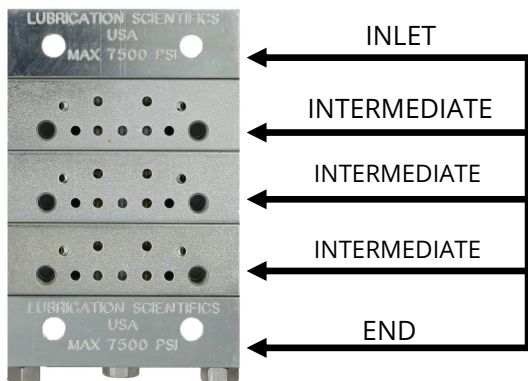

ROHS COMPLIANT CLEAR ZINC PLATING (CRS ONLY)

SUPPLIED WITH ONLY VITON O-RINGS

INTERMEDIATES INCLUDE INTEGRAL CHECKS

ALL INTERNAL CHECKS USE 316 SS BALLS AND SPRINGS

LINCOLN® STYLE BASEPLATE ASSEMBLIES AVAILABLE

STANDARD PACK: 5 EACH, 316 STAINLESS STEEL: 1 EACH

PART DESCRIPTION	CRS	303 SS	316 SS
INLET 1/4-18 NPSF	000-INL-US	303-INL-US	316-INL-US
INLET 1/4-18 NPSF LINCOLN® STYLE	000-INL-US-L	303-INL-US-L	316-INL-US-L
INLET 1/4-18 NPSF WITH BLEED PORTS	600-INL-B	603-INL-B	616-INL-B
INLET 1/4-18 NPSF LINCOLN® STYLE W/ BLEED PORTS	600-INL-B-L	603-INL-B-L	616-INL-B-L
INTERMEDIATE 1/8-27 NPSF OUTLETS	000-BP-NPSF	303-BP-NPSF	316-BP-NPSF
INTERMEDIATE 1/8-27 SAE OUTLETS	000-BP-1/8ORS	303-BP-1/8ORS	316-BP-1/8ORS
INTERMEDIATE 1/8-28 BSPP OUTLETS	000-BP-M	303-BP-M	316-BP-M
INTERMEDIATE M10 X 1.0 ISO OUTLETS	000-BP-ISO	303-BP-ISO	316-BP-ISO
INTERMEDIATE 7/16-20 SAE OUTLETS	000-BP-SAE	303-BP-SAE	316-BP-SAE
END STANDARD	000-END	303-END	316-END
END STANDARD LINCOLN® STYLE	000-END-L	303-END-L	316-END-L
END 1/8 NPSF BOTTOM INLET PORT	600-END	603-END	616-END

LINCOLN® IS A REGISTERED TRADEMARK OF LINCOLN®

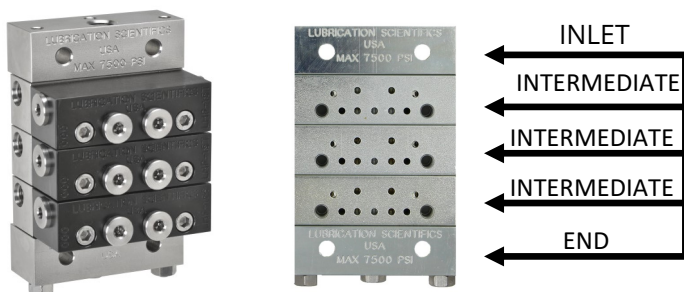

BASEPLATE ASSEMBLIES

PREBUILT & TESTED

BASEPLATE ASSEMBLIES MAKE IT EASY TO COMPLETE DIVIDER VALVE ORDER. CHOOSE DIVIDER VALVES FOR SPECIFIC NEEDS AND COMPLETE VALVE SET WITH MATCHING BASEPLATE SECTIONS. BASEPLATES ARE PREBUILT AND TESTED. BASEPLATE ASSEMBLY ORDERS COME WITH AN END, AN INLET, TIE RODS, AND BASEPLATE SECTIONS.

STANDARD PACK: 1 EACH			
SIZE & TYPE	CARBON STEEL	303 STAINLESS	316 STAINLESS
	PART #: NPSF PART #: ORS	PART #: NPSF PART #: ORS	PART #: NPSF PART #: ORS
3 SECTION WITH STANDARD INLET AND STANDARD END	BPA-03-NPSF-000 BPA-03-ORS-000	BPA-03-NPSF-303 BPA-03-ORS-303	BPA-03-NPSF-316 BPA-03-ORS-316
4 SECTION WITH STANDARD INLET AND STANDARD END	BPA-04-NPSF-000 BPA-04-ORS-000	BPA-04-NPSF-303 BPA-04-ORS-303	BPA-04-NPSF-316 BPA-04-ORS-316
5 SECTION WITH STANDARD INLET AND STANDARD END	BPA-05-NPSF-000 BPA-05-ORS-000	BPA-05-NPSF-303 BPA-05-ORS-303	BPA-05-NPSF-316 BPA-05-ORS-316
6 SECTION WITH STANDARD INLET AND STANDARD END	BPA-06-NPSF-000 BPA-06-ORS-000	BPA-06-NPSF-303 BPA-06-ORS-303	BPA-06-NPSF-316 BPA-06-ORS-316
7 SECTION WITH STANDARD INLET AND STANDARD END	BPA-07-NPSF-000 BPA-07-ORS-000	BPA-07-NPSF-303 BPA-07-ORS-303	BPA-07-NPSF-316 BPA-07-ORS-316
8 SECTION WITH STANDARD INLET AND STANDARD END	BPA-08-NPSF-000 BPA-08-ORS-000	BPA-08-NPSF-303 BPA-08-ORS-303	BPA-08-NPSF-316 BPA-08-ORS-316
9 SECTION WITH STANDARD INLET AND STANDARD END	BPA-09-NPSF-000 BPA-09-ORS-000	BPA-09-NPSF-303 BPA-09-ORS-303	BPA-09-NPSF-316 BPA-09-ORS-316
10 SECTION WITH STANDARD INLET AND STANDARD END	BPA-10-NPSF-000 BPA-10-ORS-000	BPA-10-NPSF-303 BPA-10-ORS-303	BPA-10-NPSF-316 BPA-10-ORS-316
11 SECTION WITH STANDARD INLET AND STANDARD END	BPA-11-NPSF-000 BPA-11-ORS-000	BPA-11-NPSF-303 BPA-11-ORS-303	BPA-11-NPSF-316 BPA-11-ORS-316
FOR INLET WITH BLEEDS	USE SUFFIX "-BL"		
FOR END WITH BOTTOM FEED	USE SUFFIX "-BF"		
FOR LINCOLN® STYLE INLET & END	USE SUFFIX "-L"		

ORDERING EXAMPLE WITH BLEEDS AND BOTTOM FEED: **BPA-03-NPSF-303-BL-BF**

**ORDERING INFORMATION & PART NUMBERS
INTERMEDIATE VALVE SECTIONS**

CARBON & STAINLESS STEEL DIVIDER VALVES

STANDARD FOOTPRINT, HIGH PRESSURE (7500 PSI)

ROHS COMPLIANT CLEAR ZINC PLATING (CRS ONLY)

SUPPLIED WITH ONLY STAINLESS STEEL CAPS AND MOUNTING BOLTS

SUPPLIED WITH ONLY VITON O-RINGS



ALL VALVES HAVE 1/8-27 NPSF FRONT FACE ALTERNATE OUTLETS. ALL VALVES MAY BE VERTICALLY CROSSPORTED ON THE FRONT OUTLETS. ALL VALVES CAN BE EQUIPPED WITH PERFORMANCE/RESET INDICATORS.

STANDARD PACK: 5 EACH, 316 STAINLESS STEEL: 1 EACH							
SINGLE OUTPUT	PART NUMBER			TWIN OUTPUT	PART NUMBER		
	CRS	303 SS	316 SS		CRS	303 SS	316 SS
.012 CI .197 CC	600-06S	603-06S	616-06S	.006 CI .098 CC	600-06T	603-06T	616-06T
.018 CI .295 CC	600-09S	603-09S	616-09S	.009 CI .148 CC	600-09T	603-09T	616-09T
.024 CI .393 CC	600-12S	603-12S	616-12S	.012 CI .197 CC	600-12T	603-12T	616-12T
.030 CI .492 CC	600-15S	603-15S	616-15S	.015 CI .246 CC	600-15T	603-15T	616-15T
.036 CI .590 CC	600-18S	603-18S	616-18S	.018 CI .295 CC	600-18T	603-18T	616-18T
.042 CI .688 CC	600-21S	603-21S	616-21S	.021 CI .344 CC	600-21T	603-21T	616-21T
.048 CI .787 CC	600-24S	603-24S	616-24S	.024 CI .393 CC	600-24T	603-24T	616-24T
.060 CI .983 CC	600-30S	603-30S	616-30S	.030 CI .492 CC	600-30T	603-30T	616-30T

FOR CRS BYPASS VALVE USE PART NUMBER **000-BYPASS**

FOR 303 SS BYPASS VALVE USE PART NUMBER **303-BYPASS**

FOR 316 SS BYPASS VALVE USE PART NUMBER **316-BYPASS**

**ORDERING INFORMATION & PART NUMBERS
STAINLESS STEEL TIE RODS**

303 & 316 STAINLESS STEEL TIE RODS

3 TIE RODS REQUIRED PER VALVE ASSEMBLY

ALL TIE RODS INCLUDE ROD NUT

ALL TIE RODS ARE STAINLESS STEEL

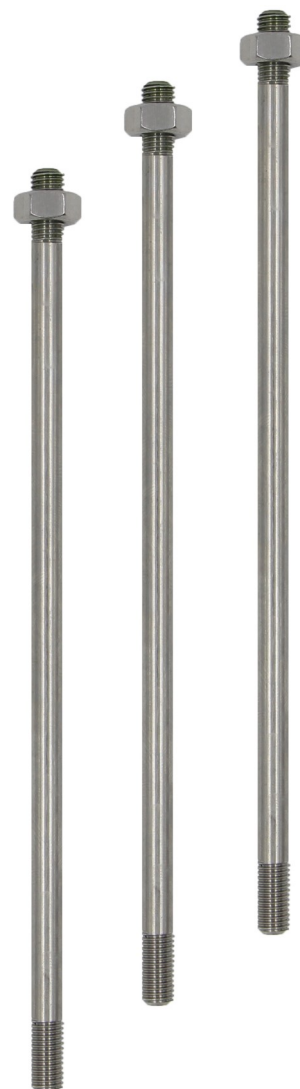

STANDARD PACK: 3 EACH		
PART DESCRIPTION	303 SS	316 SS
3 SECTION VALVE ASSEMBLY	303-TR3	316-TR3
4 SECTION VALVE ASSEMBLY	303-TR4	316-TR4
5 SECTION VALVE ASSEMBLY	303-TR5	316-TR5
6 SECTION VALVE ASSEMBLY	303-TR6	316-TR6
7 SECTION VALVE ASSEMBLY	303-TR7	316-TR7
8 SECTION VALVE ASSEMBLY	303-TR8	316-TR8
9 SECTION VALVE ASSEMBLY	303-TR9	316-TR9
10 SECTION VALVE ASSEMBLY	303-TR10	316-TR10
11 SECTION VALVE ASSEMBLY	303-TR11	316-TR11

**ORDERING INFORMATION & PART NUMBERS
SINGLING, CROSSPORTING, & REPLACEMENT PARTS**

FRONT (A/O) CROSSPORT KITS

ALL STAINLESS STEEL CONSTRUCTION WITH VITON O-RINGS

STANDARD PACK: 1 EACH		
PART DESCRIPTION	303 SS	316 SS
2 VALVES, 1 OUTPUT	303-413	316-413
3 VALVES, 1 OUTPUT	303-414	316-414
4 VALVES , 1 OUTPUT	303-415	316-415



CROSSPORT BAR KITS

CRS & STAINLESS STEEL
CONSTRUCTION WITH O-RINGS &
MOUNTING BOLTS

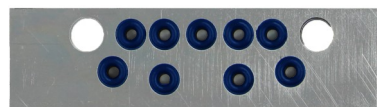

STANDARD PACK: 5 EACH			
PART DESCRIPTION	CRS	303 SS	316 SS
CROSSPORT BAR (RIGHT)	L527320	L527320-303	L527320-316
CROSSPORT BAR (LEFT)	L527330	L527330-303	L527330-316
CROSSPORT BAR (BOTH)	L527340	L527340-303	L527340-316

SINGLING BAR KIT

CARBON & STAINLESS STEEL CONSTRUCTION
WITH VITON O-RINGS

STANDARD PACK: 5 EACH			
PART DESCRIPTION	CRS	303 SS	316 SS
SINGLING BAR	L527350	L527350-303	L527350-316

REPLACEMENT CLOSURE PLUGS & O-RINGS

STAINLESS STEEL CONSTRUCTION
O-RINGS INCLUDED



STANDARD PACK: 10 EACH		
PART DESCRIPTION	303 SS	316 SS
ALTERNATE OUTLET (FRONT PORTS) PLUG	A-002-S	A-002-S316
PISTON BORE PLUG	A-001-S	A-001-S316
O-RING SEAL KIT—ALL VALVES/INTERMEDIATES/ENDS	LSP-ORSK	LSP-ORSK

**ORDERING INFORMATION & PART NUMBERS
ADDITIONAL ACCESSORIES FOR VERIFYING LUBRICATION SYSTEM FUNCTION**

NOTES REGARDING ADDITIONAL ACCESSORIES

TECHNICAL BULLETINS AVAILABLE FOR ALL ACCESSORIES. REFER TO PAGE 17 IF ADDITIONAL INFORMATION IS DESIRED ON A SPECIFIC PRODUCT.

PROXIMITY SWITCH AND CABLES

STANDARD PACK: 1 EACH				
ITEM DESCRIPTION	VALVE ADAPTER	PART NUMBER	MAX PSI/BAR	HAZARD RATING
PROXIMITY SWITCH, 3 PIN MINI-QUICK DISCONNECT	LSP/LHP	L527251	7,500 PSI 517 BAR	NO RATING
PROXIMITY SWITCH, 4 PIN MINI-QUICK DISCONNECT	LSP/LHP	L527112	7,500 PSI 517 BAR	NO RATING
PROXIMITY SWITCH, 5 PIN MINI-QUICK DISCONNECT	LSP/LHP	L527111	7,500 PSI 517 BAR	NO RATING
PROXIMITY SWITCH, EXPLOSION PROOF, 1/2" NPT WITH LEADS	LSP/LHP	L527431	7,500 PSI 517 BAR	CLASS I, GROUPS A,B,C,D CLASS II, GROUPS E,F,G CLASS III



STANDARD PACK: 1 CABLE	
ITEM DESCRIPTION	12' CABLE PART NUMBER
12' 3 PIN CABLE	L527251-CBL12
12' 4 PIN CABLE	L527112-CBL12
12' 5 PIN CABLE	L527111-CBL12

ORDERING INFORMATION & PART NUMBERS
ADDITIONAL ACCESSORIES FOR VERIFYING LUBRICATION SYSTEM FUNCTION
OUTLET CHECK VALVES

STANDARD PACK: 5 EACH					
CHECK VALVE DESCRIPTION			PART NUMBER		
INLET SIZE	OUTLET SIZE	BALL OPEN PSI	303 STAINLESS	316 STAINLESS	ADAPTER REQUIREMENTS
1/8" NPTF (M)	1/4" TUBE	35	OCV-303-125-NPTF	OCV-316-125-NPTF	INTEGRAL FITTING
1/8" ORS (M)	1/4" TUBE	35	OCV-303-125-ORS	OCV-316-125-ORS	INTEGRAL FITTING
1/8" BSPP (M)	6MM TUBE	35	OCV-303-125-BSPP	OCV-316-125-BSPP	INTEGRAL FITTING
M10 X 1.0 ISO (M)	6MM TUBE	35	OCV-303-125-ISO	OCV-316-125-ISO	INTEGRAL FITTING
7/16"-20 SAE (M)	1/4" TUBE	35	OCV-303-125-SAE	OCV-316-125-SAE	INTEGRAL FITTING

STANDARD PACK: 5 EACH					
CHECK VALVE DESCRIPTION			PART NUMBER		
INLET SIZE	OUTLET SIZE	BALL OPEN PSI / BAR	303 STAINLESS	316 STAINLESS	ADAPTER REQUIREMENTS
1/8" NPTF (M)	1/8" NPSF (F)	35 / 2.41	OCV-303-125R-35	OCV-316-125R-35	TUBE FITTING
1/8" NPTF (M)	1/8" NPSF (F)	60 / 4.13	OCV-303-125R-60	OCV-316-125R-60	TUBE FITTING
1/8" NPTF (M)	1/8" NPSF (F)	250 / 17.23	OCV-303-125R-250	OCV-316-125R-250	TUBE FITTING
1/4"NPTF (M)	1/4" NPSF (F)	35 / 2.41	OCV-303-250R-35	OCV-316-250R-35	TUBE FITTING

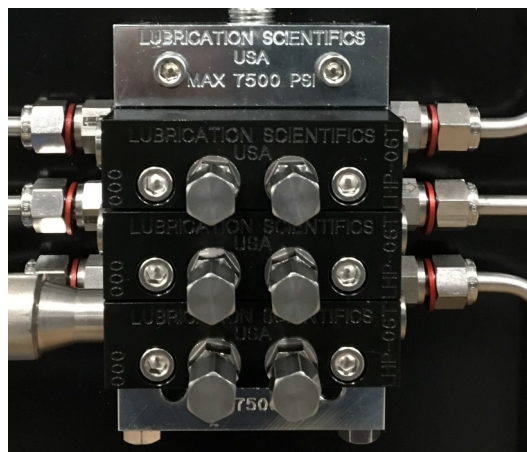

ORDERING INFORMATION & PART NUMBERS
ADDITIONAL ACCESSORIES FOR VERIFYING LUBRICATION SYSTEM FUNCTION

VISUAL CYCLE INDICATOR

STANDARD PACK: 1 EACH	
ITEM DESCRIPTION	PART NUMBER
STAINLESS STEEL VISUAL CYCLE INDICATOR	VCI-437-L LINCOLN® STYLE



LIMIT SWITCH

STANDARD PACK: 1 EACH	
ITEM DESCRIPTION	PART NUMBER
LIMIT SWITCH ASSEMBLY, SPDT	LSW-001
LIMIT SWITCH ASSEMBLY, DPDT	LSW-002

PERFORMANCE (RESET) INDICATORS

STANDARD PACK: 5 EACH	1/8 NPSF O-RING CONNECTION	
	303 STAINLESS	316 STAINLESS
1,000 PSI 69 BAR	303-P1000	316-P1000
1,500 PSI 103 BAR	303-P1500	316-P1500
2,000 PSI 138 BAR	303-P2000	316-P2000
2,500 PSI 172 BAR	303-P2500	316-P2500
3,000 PSI 207 BAR	303-P3000	316-P3000
3,500 PSI 241 BAR	303-P3500	316-P3500
5,000 PSI 345 BAR	303-P5000	316-P5000
LINCOLN® STYLE INDICATOR ADAPTER	303-PI-ADP-L	316-PI-ADP-L



LINCOLN® IS A REGISTERED TRADEMARK OF LINCOLN® INDUSTRIAL

ORDERING INFORMATION & PART NUMBERS
ADDITIONAL ACCESSORIES FOR VERIFYING LUBRICATION SYSTEM FUNCTION

BLOWOUT FITTINGS

STANDARD PACK: 5 EACH	1/8" O-RING SEAL OR 1/8" NPTF THREADS	
ITEM DESCRIPTION	303 STAINLESS	316 STAINLESS
LOW PRESSURE 1/8" NPSF PLAIN NUT W/ 1/4" APERTURE	BOF-LP-303-NPTF BOF-LP-303-ORS	BOF-LP-316-NPTF BOF-LP-316-ORS
LOW PRESSURE 1/8" NPSF SPUD NUT W/ 1/4" APERTURE	BOF-LP-303R-NPTF BOF-LP-303R-ORS	BOF-LP-316R-NPTF BOF-LP-316R-ORS
HIGH PRESSURE 1/8" NPSF PLAIN NUT W/ 1/8" APERTURE	BOF-HP-303-NPTF BOF-HP-303-ORS	BOF-HP-316-NPTF BOF-HP-316-ORS
HIGH PRESSURE 1/8" NPSF SPUD NUT W/ 1/8" APERTURE	BOF-HP-303R-NPTF BOF-HP-303R-ORS	BOF-HP-316R-NPTF BOF-HP-316R-ORS



NOTE: RUPTURE DISK NOT INCLUDED

3/8" DIAMETER RUPTURE DISKS

STANDARD PACK: 25 EACH			
DISC COLOR	LOW PRESSURE BURST (PSI / BAR) (1/4" APERTURE FITTING)	HIGH PRESSURE BURST (PSI / BAR) (1/8" APERTURE FITTING)	PART NUMBER
BLACK	900 / 62	N/R	A509-276-000
GREEN	1,175 / 81	N/R	A509-277-000
YELLOW	1,450 / 100	3,700 / 255	A509-292-000
RED	1,750 / 121	4,600 / 317	A509-279-000
ORANGE	2,050 / 141	5,500 / 379	A509-280-000
ALUMINUM	2,350 / 162	N/R	A509-281-000
PINK	2,650 / 183	6,400 / 441	A509-282-000
BLUE	2,950 / 203	7,300 / 503	A509-283-000
PURPLE	3,250 / 224	8,200 / 565	A509-284-000

NOTE: ALL DISKS HAVE A RUPTURE TOLERANCE OF +500 PSI

ORDERING INFORMATION & PART NUMBERS

ADDITIONAL ACCESSORIES FOR VERIFYING LUBRICATION SYSTEM FUNCTION

ATMOSPHERIC RESET INDICATORS

PART NUMBER	DESCRIPTION
L5081000-NPTF	ATMOSPHERIC RESET INDICATOR, 1000 PSI, 1/8 NPTF
L5081000-ORS	ATMOSPHERIC RESET INDICATOR, 1000 PSI, 1/8 ORS
L5081500-NPTF	ATMOSPHERIC RESET INDICATOR, 1500 PSI, 1/8 NPTF
L5081500-ORS	ATMOSPHERIC RESET INDICATOR, 1500 PSI, 1/8 ORS
L5082000-NPTF	ATMOSPHERIC RESET INDICATOR, 2000 PSI, 1/8 NPTF
L5082000-ORS	ATMOSPHERIC RESET INDICATOR, 2000 PSI, 1/8 ORS
L5082500-NPTF	ATMOSPHERIC RESET INDICATOR, 2500 PSI, 1/8 NPTF
L5082500-ORS	ATMOSPHERIC RESET INDICATOR, 2500 PSI, 1/8 ORS
L5083000-NPTF	ATMOSPHERIC RESET INDICATOR, 3000 PSI, 1/8 NPTF
L5083000-ORS	ATMOSPHERIC RESET INDICATOR, 3000 PSI, 1/8 ORS
L5081000-316-NPTF	316 ATMOSPHERIC RESET INDICATOR, 1000 PSI, 1/8 NPT
L5081000-316-ORS	316 ATMOSPHERIC RESET INDICATOR, 1000 PSI, 1/8 ORS
L5081500-316-NPTF	316 ATMOSPHERIC RST INDICATOR, 1500 PSI, 1/8 NPTF
L5081500-316-ORS	316 ATMOSPHERIC RESET INDICATOR, 1500 PSI, 1/8 ORS
L5082000-316-NPTF	316 ATMOSPHERIC RST INDICATOR, 2000 PSI, 1/8 NPTF
L5082000-316-ORS	316 ATMOSPHERIC RST INDICATOR, 2000 PSI, 1/8 ORS
L5082500-316-NPTF	316 ATMOSPHERIC RST INDICATOR, 2500 PSI, 1/8 NPTF
L5082500-316-ORS	316 ATMOSPHERIC RST INDICATOR, 2500 PSI, 1/8 ORS
L5083000-316-NPTF	316 ATMOSPHERIC RST INDICATOR, 3000 PSI, 1/8 NPTF
L5083000-316-ORS	316 ATMOSPHERIC RST INDICATOR, 3000 PSI, 1/8 ORS

ORDERING INFORMATION & PART NUMBERS
ADDITIONAL ACCESSORIES FOR VERIFYING LUBRICATION SYSTEM FUNCTION

STANDARD PACK: 5 EACH			
PRODUCT DESCRIPTION	CARBON STEEL	303 STAINLESS STEEL	316 STAINLESS STEEL
4 WAY CROSS 1/8 NPSF (X4) 9/32 MTG HOLE	L509189-000	L509189-303	L509189-316
4 WAY CROSS 1/4 NPSF (X4) 9/32 MTG HOLE	L509188-000	L509188-303	L509188-316
5 WAY CROSS 1/4 NPSF (X4) 1/8 NPSF (X1) 9/32 MTG HOLE	L509190-000	L509190-303	L509190-316
2 WAY STRAIGHT 1/8 NPSF (X2) 9/32 MTG HOLE	L509180-000	L509180-303	L509180-316
2 WAY STRAIGHT 1/4 NPSF (X2) 9/32 MTG HOLE	L509185-000	L509185-303	L509185-316
90 DEGREE ELBOW 1/8 NPSF (X2) 9/32 MTG HOLE	L509170-000	L509170-303	L509170-316
90 DEGREE ELBOW 1/4 NPSF (X2) 9/32 MTG HOLE	L509175-000	L509175-303	L509175-316



ORDERING INFORMATION & PART NUMBERS
ADDITIONAL ACCESSORIES FOR VERIFYING LUBRICATION SYSTEM FUNCTION

CONTAMINATION IS THE ENEMY OF RELIABILITY
THE DIRT TRAP IS THE ANSWER

DIRT TRAP FILTER ASSEMBLY



STANDARD PACK: 1 EACH		
FILTER RATING	316 STAINLESS STEEL	AL2024 BLUE ANODIZED ALUMINUM 6,000 PSI / 414 BAR
5 MICRON	DTFA-005-O-316	MDFA-005-O
10 MICRON	DTFA-010-O-316	MDFA-010-O
25 MICRON	DTFA-025-O-316	MDFA-025-O
150 MICRON 100 MESH	DTFA-100-G-316	MDFA-100-G
420 MICRON 40 MESH	DTFA-040-G-316	MDFA-040-G

DIRT TRAP REPLACEMENT ELEMENT - STANDARD PACK 1 EA.

STANDARD PACK: 1 EACH	
FILTER RATING	PART NUMBER
5 MICRON	DT-EL-002-005MIC
10 MICRON	DT-EL-002-010MIC
25 MICRON	DT-EL-002-025MIC
150 MICRON 100 MESH	DT-EL-002-100M



NOTE: REPLACEMENT ELEMENTS ARE COMPATIBLE WITH BOTH THE CARBON STEEL AND 2024 ALUMINUM MODELS.

ORDERING INFORMATION & PART NUMBERS

SPIN-ON FILTER ASSEMBLY

ANODIZED ALUMINUM MANIFOLD
 STAINLESS STEEL PRESSURE GAUGES
 MOUNTING BRACKET
 HIGH FLOW FILTER CANISTER
 FOR OIL USE ONLY
 MAX PRESSURE: 150 PSI

STANDARD PACK: 1 EACH	
PART DESCRIPTION	PART NUMBER
SPIN-ON FILTER COMPLETE ASSEMBLY	LPFA-118-AL
REPLACEMENT ELEMENT	LPFA-118-RFE



SPIN-ON-FILTER COMPLETE ASSEMBLY



REPLACEMENT ELEMENT

LHP FEEDER PART NUMBER ORDERING GUIDE

LHP-XXX-XXX-XX-XX-XXX-XXXXX

LHP-XXX-XXX-XX-XX-XXX-XXXXX	
MATERIAL	P/N
CARBON STEEL	LEAVE BLANK
303 STAINLESS	303
316 STAINLESS	316

LHP-XXX-XXX-XX-XX-XXX-XXXXX	
PORT OPTIONS	P/N
NPSF PORTS	NPT
1/8 ORS	ORS
SAE PORTS	SAE
BSPP PORTS	BSP
METRIC PORTS	MET

LHP-XXX-XXX-XX-XX-XXX-XXXXX	
VALVE SIZE	P/N
BYPASS SECTION	BP
.006 CU. IN.	6
.009 CU. IN.	9
.012 CU. IN.	12
.015 CU. IN.	15
.018 CU. IN.	18
.024 CU. IN.	24
.030 CU. IN.	30

LHP-XXX-XXX-XX-XX-XXX-XXXXX	
INLET SECTION OPTION	P/N
STANDARD	MS
W/ BLEED SCREWS (NPT PORT OPTION ONLY)	MB

LHP-XXX-XXX-XX-XX-XXX-XXXXX	
END SECTION OPTION	P/N
STANDARD	ES
WITH 1/8-27 NPSF PORT	EP

LHP-XXX-XXX-XX-XX-XXX-XXXXX	
INSTALLED ACCESSORIES	P/N
NO INTERNAL CHECK VALVES	X
EXTERNAL CHECK VALVES	C
PERFORMANCE INDICATORS	P
PERFORMANCE INDICATORS & CHECK VALVES	B

LHP-XXX-XXX-XX-XX-XXX-XXXXX	
NUMBER OF SECTIONS	P/N
THREE	3
FOUR	4
FIVE	5
SIX	6
SEVEN	7
EIGHT	8
NINE	9
TEN	10
ELEVEN	11

LHP-XXX-XXX-XX-XX-XXX-XXXXX	
TYPE OF SECTION	P/N
TWIN	T
SINGLE, RH OUTLET	S
SINGLE, LH OUTLET	L
TWIN, PROXIMITY SWITCH RIGHT	E
SINGLE, PROXIMITY SWITCH RIGHT, RH OUTLET	F
SINGLE, PROXIMITY SWITCH RIGHT, LH OUTLET	G
TWIN, PROXIMITY SWITCH LEFT	M
SINGLE, PROXIMITY SWITCH LEFT, RH OUTLET	N
SINGLE, PROXIMITY SWITCH LEFT, LH OUTLET	P

LHP-XXX-XXX-XX-XX-XXX-XXXXX	
CROSSPORT OPTION	P/N
RIGHT SIDE	CR
LEFT SIDE	CL
BOTH SIDES	CB

MOUNTING INFORMATION & SPECIFICATIONS

WITH 1.75" STANDARD MOUNTING HOLES

VALVE SECTIONS	A		B	C	D	E
	INCH	mm				
3	3.585/3.605	91.31	1.75	0.490	0.490	0.281
4	4.510/4.530	114.80	1.75	0.490	0.490	0.281
5	5.435/5.455	138.30	1.75	0.490	0.490	0.281
6	6.360/6.380	161.79	1.75	0.490	0.490	0.281
7	7.285/7.305	185.29	1.75	0.490	0.490	0.281
8	8.210/8.230	208.78	1.75	0.490	0.490	0.281

VALVE SECTIONS	NET WEIGHT	
	LBS.	KG.
3	5.9	2.7
4	7.3	3.3
5	8.7	4.0
6	10.2	4.6
7	11.6	5.6
8	13.0	5.9

WITH 1.875" MOUNTING HOLES

VALVE SECTIONS	A		B	C	D	E
	INCH	mm				
3	3.365/3.385	85.72	1.875	0.292	0.310	0.328
4	4.290/4.310	109.22	1.875	0.292	0.310	0.328
5	5.215/5.235	132.71	1.875	0.292	0.310	0.328
6	6.140/6.160	156.21	1.875	0.292	0.310	0.328
7	7.065/7.085	179.70	1.875	0.292	0.310	0.328
8	7.990/8.010	203.20	1.875	0.292	0.310	0.328

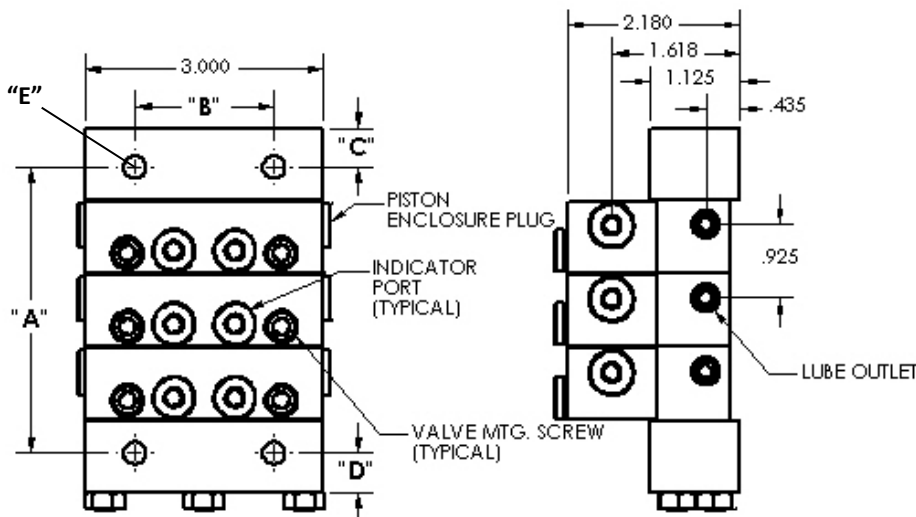
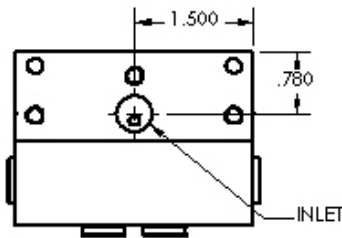

SPECIFICATIONS

MATERIAL: ZINC PLATED STEEL, SS303, SS316

MAX CYCLE RATE (OIL) 200 CPM

MAX PRESSURE: 7500 PSI

TORQUE SPECIFICATIONS

TIE ROD NUT: 5-8 FT/LBS

VALVE MOUNTING BOLTS: 72 IN/LBS

ALT. OUTLET PORTS: 8-9 FT/LBS

PISTON CLOSURE PORT: 12-15 FT/LBS

PRODUCT INTERCHANGE—LHP DIVIDER VALVES

LUBRICATION SCIENTIFICS	LUBRIQUIP	GRACO	LINCOLN®	FARVAL	PRODUCT DESCRIPTION
000-INL-SAE	N/A	N/A	N/A	N/A	LHP CRS INLET 7/16-20 SAE
000-INL-M	N/A	N/A	N/A	N/A	LHP CRS INLET 1/4" -19 BSPP
000-INL-ISO	N/A	N/A	N/A	N/A	LHP CRS INLET M10 X 1.0 ISO
600-INL-B	527-000-321	N/A	N/A	N/A	LHP CRS INLET 1/4" NPSF WITH BLEED SCREW
600-INL-B-SAE	527-000-325	563422	N/A	N/A	LHP CRS INLET 7/16-20 SAE WITH BLEED SCREW
L527330	527-005-330	563470	N/A	N/A	LHP CRS CROSSPORT PLATE LEFT HAND
L527320	527-005-320	563469	N/A	N/A	LHP CRS CROSSPORT PLATE RIGHT HAND
L527340	527-005-340	563471	N/A	N/A	LHP CRS CROSSPORT PLATE BOTH
600-BYPASS	106-000-010	562660	874000	N/A	LHP CRS BY-PASS SECTION
L527350	527-005-350	563472	N/A	N/A	LHP CRS SINGLING PLATE
600-BP-NPSF	527-000-311	563419	68645	N/A	LHP CRS BASE PLATE 1/8-27 NPSF
600-BP-1/8ORS	N/A	N/A	N/A	N/A	LHP CRS BASE PLATE 1/8 WITH O-RING
600-BP-SAE	527-003-550	563451	N/A	N/A	LHP CRS BASE PLATE 7/16-20 SAE
600-BP-M	N/A	N/A	N/A	N/A	LHP CRS BASE PLATE 1/8-28 BSPP
600-BP-ISO	N/A	N/A	N/A	N/A	LHP CRS BASE PLATE M10.0 X 1.0 ISO
000-END	527-001-900	563428	87956	N/A	LHP CRS END PLATE
600-END	N/A	N/A	N/A	N/A	LHP CRS END WITH ALT. INLET 1/8" NPSF
LSP-ORSK	N/A	N/A	N/A	N/A	LHP CRS VALVE AND BASE PLATE O-RINGS VITON
LSP-TRN-SS	410-440-010	556371	N/A	N/A	LHP CRS TIE ROD NUT 1/4"-28 HEX
303-TR3	527-001-930	557731	236640	N/A	LHP CRS 3-SECTION TIE ROD & NUT (PACK OF 3 EACH)
303-TR4	527-001-940	557732	236641	N/A	LHP CRS 4-SECTION TIE ROD & NUT (PACK OF 3 EACH)
303-TR5	527-001-950	557733	236642	N/A	LHP CRS 5-SECTION TIE ROD & NUT (PACK OF 3 EACH)
303-TR6	527-001-960	557734	236643	N/A	LHP CRS 6-SECTION TIE ROD & NUT (PACK OF 3 EACH)
303-TR7	527-001-970	557735	236644	N/A	LHP CRS 7-SECTION TIE ROD & NUT (PACK OF 3 EACH)
303-TR8	527-001-980	557736	236645	N/A	LHP CRS 8-SECTION TIE ROD & NUT (PACK OF 3 EACH)
303-TR9	N/A	N/A	N/A	N/A	LHP CRS 9-SECTION TIE ROD & NUT (PACK OF 3 EACH)
303-TR10	N/A	N/A	N/A	N/A	LHP CRS 10-SECTION TIE ROD & NUT (PACK OF 3 EACH)
303-TR11	N/A	N/A	N/A	N/A	LHP CRS 11-SECTION TIE ROD & NUT (PACK OF 3 EACH)
LSP-VMB-303	419-140-070	556513	N/A	N/A	LHP CRS BASE ASSEMBLY SCREWS 1/4-28
N/A	N/A	N/A	N/A	N/A	CRS ELEMENT SCREWS 1/4-28
N/A	N/A	N/A	N/A	N/A	CRS 1/4-28 THREADED INSERT
A-001-S	527-000-232	557716	N/A	N/A	LHP CRS PISTON CLOSURE PLUG WITH O-RING
A-002-S	527-300-840	557776	N/A	N/A	LHP CRS ALTERNATE OUTLET PLUG WITH O-RING
131-1827PP	N/A	N/A	N/A	N/A	LHP CRS OUTLET PORT PLUG 1/8-20 NPSF
131-1828PP	N/A	N/A	N/A	N/A	LHP CRS OUTLET PORT PLUG 1/8-28 BSPP
A-001-S	N/A	N/A	N/A	N/A	LHP CRS OUTLET PORT PLUG 2-SAE
131-M10PP	N/A	N/A	N/A	N/A	LHP CRS OUTLET PLUG M10 X 1.0 ISO
600-06S	106-000-025	562661	876061	N/A	LHP CRS 06SINGLE
600-06T	106-000-085	562667	876062	N/A	LHP CRS 06TWIN
600-09S	106-000-035	565662	876091	N/A	LHP CRS 09 SINGLE
600-09T	106-000-095	562668	876092	N/A	LHP CRS 09 TWIN
600-12S	106-000-045	562663	876121	N/A	LHP CRS 12 SINGLE
600-12T	106-000-105	562669	876122	N/A	LHP CRS 12 TWIN
600-18S	106-000-055	562664	876181	N/A	LHP CRS 18 SINGLE
600-18T	106-000-115	562670	876182	N/A	LHP CRS 18 TWIN
600-24S	106-000-065	562665	876241	N/A	LHP CRS 24 SINGLE
600-24T	106-000-125	562671	876242	N/A	LHP CRS 24 TWIN
600-30S	106-000-075	562666	N/A	N/A	LHP CRS 30 SINGLE
600-30T	106-000-135	562672	N/A	N/A	LHP CRS 30 TWIN
600-12S-RHCIP	N/A	N/A	876123	N/A	LHP CRS 12 SGL RHCIP
600-12T-RHCIP	N/A	N/A	876124	N/A	LHP CRS 12 TW RHCIP
600-18S-RHCIP	106-000-205	562674	876124	N/A	LHP CRS 18 SGL RHCIP
600-18T-RHCIP	106-000-235	562676	876184	N/A	LHP CRS 18 TW RHCIP
600-24S-RHCIP	106-000-215	564252	876243	N/A	LHP CRS 24 SGL RHCIP
600-24T-RHCIP	106-000-245	562677	876244	N/A	LHP CRS 24 TW RHCIP
600-30S-RHCIP	106-000-225	562675	N/A	N/A	LHP CRS 30 SGL RHCIP
600-30T-RHCIP	106-000-255	562678	N/A	N/A	LHP CRS 30 TW RHCIP
600-12S-LHCIP	N/A	N/A	N/A	N/A	LHP CRS 15 SGL LHCIP
600-12T-LHCIP	N/A	N/A	N/A	N/A	LHP CRS 15 TW LHCIP
600-18S-LHCIP	N/A	N/A	N/A	N/A	LHP CRS 20 SGL LHCIP
600-18T-LHCIP	N/A	N/A	N/A	N/A	LHP CRS 20 TW LHCIP
600-24S-LHCIP	N/A	N/A	N/A	N/A	LHP CRS 25 SGL LHCIP
600-24T-LHCIP	N/A	N/A	N/A	N/A	LHP CRS 25 TW LHCIP
600-30S-LHCIP	N/A	N/A	N/A	N/A	LHP CRS 30 SGL LHCIP
600-30T-LHCIP	N/A	N/A	N/A	N/A	LHP CRS 30 TW LHCIP
LSP-CIPSK	N/A	N/A	N/A	N/A	LHP CYCLE PIN REPAIR KIT

*LINCOLN® IS A REGISTERED TRADEMARK OF LINCOLN® INDUSTRIAL
 GRACO® IS A REGISTERED TRADEMARK OF GRACO®
 TRABON® IS A REGISTERED TRADEMARK OF GRACO®
 FARVAL® IS A REGISTERED TRADEMARK OF BIJUR DELIMON INTERNATIONAL

DISCLAIMER: Lubrication Scientifics, LLC assumes no responsibility for errors or omissions which may have occurred. While every effort is made to attain accurate information, it is ultimately the responsibility of the distributor and/or customer to verify the accuracy of the information.

CONTACT US

IN THE USA, FIND YOUR STATE IN THE MAP BELOW, LOOK FOR THE REGION ID NUMBER AND FIND THAT NUMBER IN THE CONTACT INFORMATION CHART.



1	Call Factory Direct - 877-452-0157	7	Richard Hanley - California - Santa Barbara, Ventura, Los Angeles, Orange, San Bernardino, Riverside, San Diego and Imperial Counties. Nevada - Clark County. Cell: 714-625-5539 Email: rth@lubricationscientifics.com
2	Call Factory Direct - 877-452-0157	8	California - All Counties not covered by Richard. Nevada - All Counties except Clark County. Call Factory Direct - 877-452-0157
3	Call Factory Direct - 877-452-0157	9	Call Factory Direct - 877-452-0157
4	Andy Kromer Cell: 440-364-4721 Email: aklub@lubricationscientifics.com	10	Call Factory Direct - 877-452-0157
5	Call Factory Direct - 877-452-0157		
6	Cory Walker Cell: 832-585-7065 Email: c.walker@lubricationscientifics.com		

Outside of the United States	Call Factory Direct - 877-452-0157
------------------------------	------------------------------------

Customer Service (877-452-0157)

- ◆ Order status & order entry
- ◆ Pricing inquiries
- ◆ Part number look-ups
- ◆ Product availability information
- ◆ Shipment assistance
- ◆ All other general inquires

www.lubricationscientifics.com

- ◆ Product information, specifications, literature
- ◆ Locate sales reps and distributors
- ◆ Operator & Repair manuals
- ◆ Distributer Information
- ◆ Place orders and check current pricing
- ◆ Product Pricing

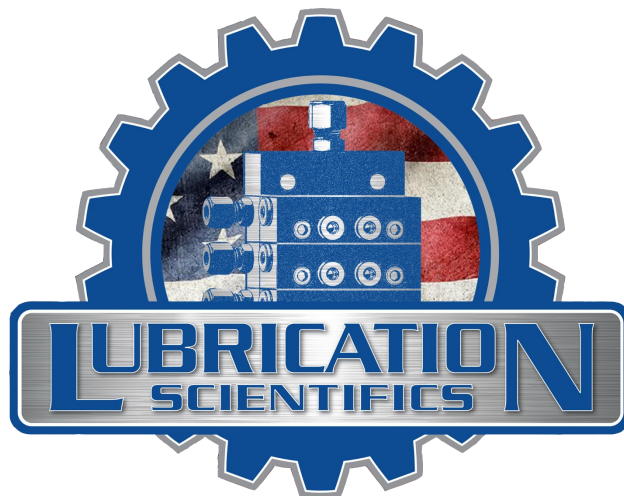

LUBRICATION SCIENTIFICS, LLC

17651 ARMSTRONG AVE.

IRVINE, CA 92614

UNITED STATES OF AMERICA

TOLL FREE TEL: (877) 452-0157, LOCAL TEL: (714) 557-0664, FAX: (714) 546-4564

WWW.LUBRICATIONSCIENTIFICS.COM