

LUBRICATION SCIENTIFICS, LLC

THE RIGHT PRODUCTS. THE RIGHT VALUES. THE RIGHT CHOICE.



LSP SERIES PROGRESSIVE DIVIDER VALVE SYSTEMS
STANDARD PRESSURE VALVES—CRITICAL MONITORING—ACCESSORIES



LSP—STANDARD PRESSURE, SERIES PROGRESSIVE DIVIDER VALVE

PRODUCT DESCRIPTION

STANDARD PRESSURE, SERIES PROGRESSIVE DIVIDER VALVES

IDEAL FOR INDUSTRIAL, MARINE, AND FOOD PROCESSING MACHINERY

AVAILABLE IN PLATED CARBON, 303, AND 316 STAINLESS STEEL

DESIGNED WITH FEEDBACK MONITORING SYSTEM PERFORMANCE

INTEGRAL CHECK VALVES STANDARD KEEPING LUBE LINES FULL

CAN ACCOMMODATE 1-22 LUBE POINTS PER VALVE ASSEMBLY

BENEFITS & FEATURES

PRECISE LUBRICANT FLOW TO EACH LUBE POINT

STANDARD FOOTPRINT AND PRESSURE, 3500 PSI

INTERNAL CHECK VALVES

CARBON OR STAINLESS STEEL CONSTRUCTION

USED FOR LOW PRESSURE OIL OR GREASE APPLICATIONS

1-22 LUBE POINTS PER VALVE ASSEMBLY

ALL INTEGRAL CHECKS USE 316 STAINLESS STEEL BALLS AND SPRINGS

WIDE RANGE OF ACCESSORIES AVAILABLE FOR ANY SYSTEM REQUIREMENT

COMPLETE BASEPLATE ASSEMBLIES AVAILABLE

READY FOR IMMEDIATE SHIPMENT

MADE IN



WWW.LUBRICATIONSCIENTIFICS.COM

FUNCTION ILLUSTRATION & SPECIFICATIONS

PRECISE LUBRICATION IS ESSENTIAL FOR PROPER MECHANICAL PERFORMANCE. PUMPS PROVIDE MEASURED PRESSURIZED LUBRICATION TO MASTER VALVE. MASTER VALVE DISTRIBUTES A MEASURED AMOUNT OF LUBRICATION TO CORRESPONDING SECONDARY VALVES. SECONDARY VALVES DISTRIBUTE MEASURED LUBRICATION TO VARIOUS LUBE POINTS IN SYSTEM.

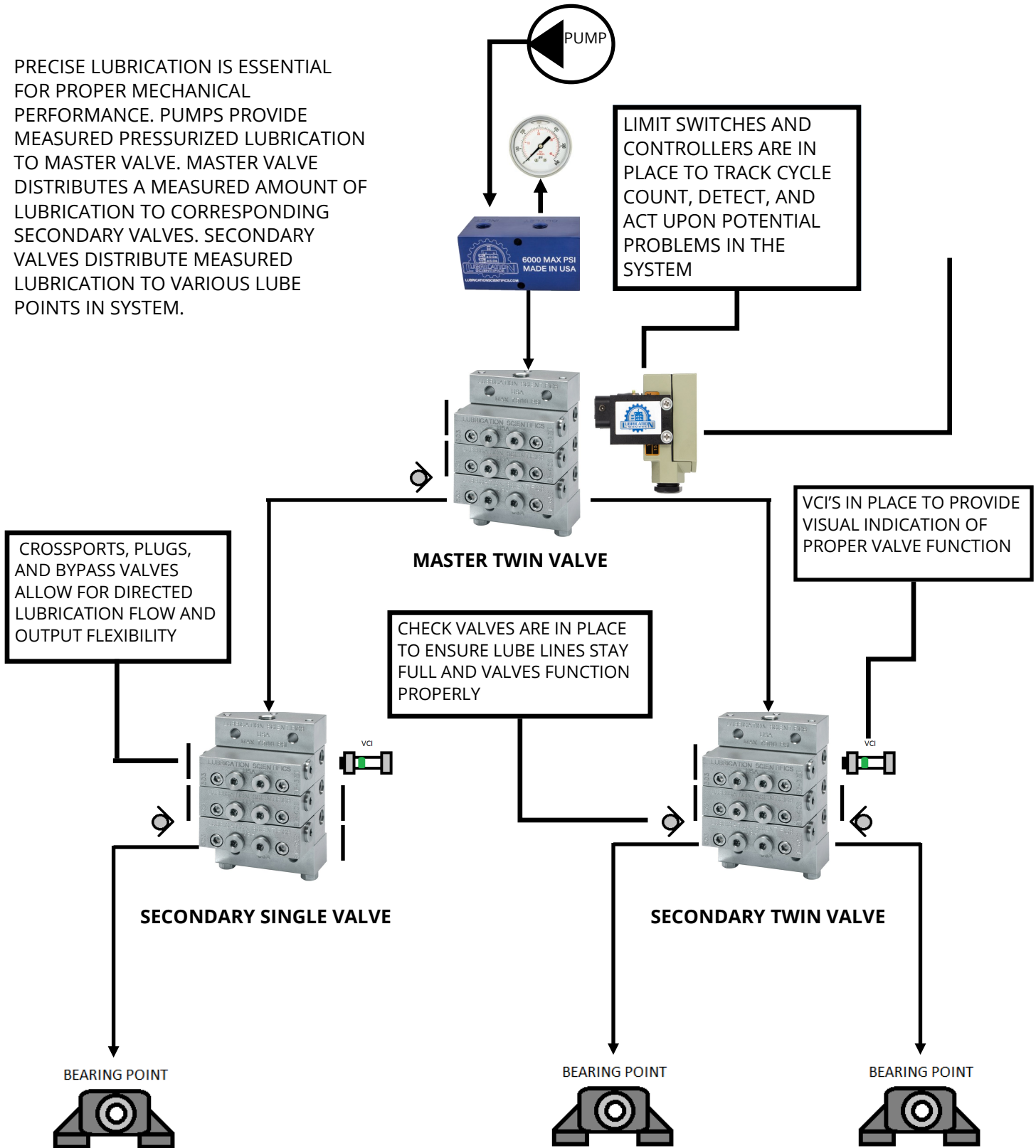

**ORDERING INFORMATION & PART NUMBERS
MANIFOLD COMPONENTS—INLETS, OUTLETS, & ENDS**

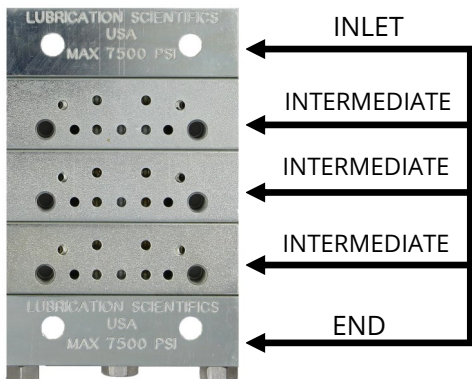

MANIFOLD COMPONENTS

ROHS COMPLIANT CLEAR ZINC PLATING (CRS ONLY)

SUPPLIED WITH ONLY VITON O-RINGS

INTERMEDIATES INCLUDE INTEGRAL CHECKS

ALL INTERNAL CHECKS USE 316 SS BALLS AND SPRINGS

LINCOLN® STYLE BASE PLATE ASSEMBLIES AVAILABLE

STANDARD PACK: 5 EACH, 316 STAINLESS STEEL: 1 EACH			
PART DESCRIPTION	CRS	303 SS	316 SS
INLET WITH 1/4-18 NPSF INLET PORT	000-INL-US	303-INL-US	316-INL-US
INLET WITH 1/4-19 BSPP INLET PORT	000-INL-M	303-INL-M	316-INL-M
INLET WITH 7/16-20 SAE INLET PORT	000-INL-SAE	303-INL-SAE	316-INL-SAE
INLET WITH M10 X 1.0 ISO INLET PORT	000-INL-ISO	303-INL-ISO	316-INL-ISO
INTERMEDIATE WITH 1/8-27 NPSF OUTLETS	000-BP-NPSF	303-BP-NPSF	316-BP-NPSF
INTERMEDIATE WITH 1/8-27 SAE OUTLETS	000-BP-1/8ORS	303-BP-1/8ORS	316-BP-1/8ORS
INTERMEDIATE WITH 7/16-20 SAE OUTLETS	000-BP-SAE	303-BP-SAE	316-BP-SAE
INTERMEDIATE WITH 1/8-28 BSPP OUTLETS	000-BP-M	303-BP-M	316-BP-M
INTERMEDIATE WITH M10 X 1.0 ISO OUTLETS	000-BP-ISO	303-BP-ISO	316-BP-ISO
END (ALL)	000-END	303-END	316-END
LINCOLN® STYLE INLET	000-INL-US-L	303-INL-US-L	316-INL-US-L
LINCOLN® STYLE END	000-END-L	303-END-L	316-END-L

LINCOLN® IS A REGISTERED TRADEMARK OF LINCOLN®

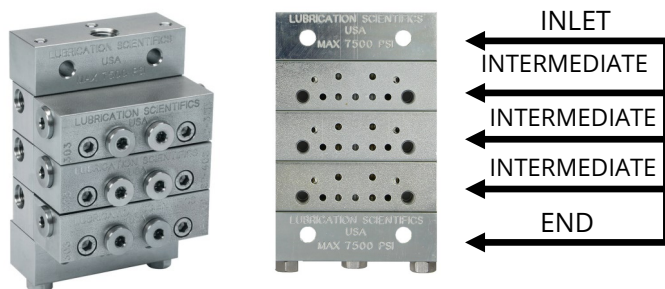

BASEPLATE ASSEMBLIES

PREBUILT & TESTED

BASEPLATE ASSEMBLIES MAKE IT EASY TO COMPLETE DIVIDER VALVE ORDER. CHOOSE DIVIDER VALVES FOR SPECIFIC NEEDS AND COMPLETE VALVE SET WITH MATCHING BASEPLATE SECTIONS. BASEPLATES ARE PREBUILT AND TESTED. BASEPLATE ASSEMBLY ORDERS COME WITH AN END, AN INLET, TIE RODS, AND BASEPLATE SECTIONS.

STANDARD PACK: 1 EACH			
SIZE & TYPE	CARBON STEEL	303 STAINLESS	316 STAINLESS
	PART #: NPSF PART #: ORS	PART #: NPSF PART #: ORS	PART #: NPSF PART #: ORS
3 SECTION WITH STANDARD INLET AND STANDARD END	BPA-03-NPSF-000 BPA-03-ORS-000	BPA-03-NPSF-303 BPA-03-ORS-303	BPA-03-NPSF-316 BPA-03-ORS-316
4 SECTION WITH STANDARD INLET AND STANDARD END	BPA-04-NPSF-000 BPA-04-ORS-000	BPA-04-NPSF-303 BPA-04-ORS-303	BPA-04-NPSF-316 BPA-04-ORS-316
5 SECTION WITH STANDARD INLET AND STANDARD END	BPA-05-NPSF-000 BPA-05-ORS-000	BPA-05-NPSF-303 BPA-05-ORS-303	BPA-05-NPSF-316 BPA-05-ORS-316
6 SECTION WITH STANDARD INLET AND STANDARD END	BPA-06-NPSF-000 BPA-06-ORS-000	BPA-06-NPSF-303 BPA-06-ORS-303	BPA-06-NPSF-316 BPA-06-ORS-316
7 SECTION WITH STANDARD INLET AND STANDARD END	BPA-07-NPSF-000 BPA-07-ORS-000	BPA-07-NPSF-303 BPA-07-ORS-303	BPA-07-NPSF-316 BPA-07-ORS-316
8 SECTION WITH STANDARD INLET AND STANDARD END	BPA-08-NPSF-000 BPA-08-ORS-000	BPA-08-NPSF-303 BPA-08-ORS-303	BPA-08-NPSF-316 BPA-08-ORS-316
9 SECTION WITH STANDARD INLET AND STANDARD END	BPA-09-NPSF-000 BPA-09-ORS-000	BPA-09-NPSF-303 BPA-09-ORS-303	BPA-09-NPSF-316 BPA-09-ORS-316
10 SECTION WITH STANDARD INLET AND STANDARD END	BPA-10-NPSF-000 BPA-10-ORS-000	BPA-10-NPSF-303 BPA-10-ORS-303	BPA-10-NPSF-316 BPA-10-ORS-316
11 SECTION WITH STANDARD INLET AND STANDARD END	BPA-11-NPSF-000 BPA-11-ORS-000	BPA-11-NPSF-303 BPA-11-ORS-303	BPA-11-NPSF-316 BPA-11-ORS-316
FOR INLET WITH BLEEDS	USE SUFFIX "-BL"		
FOR END WITH BOTTOM FEED	USE SUFFIX "-BF"		
FOR LINCOLN® STYLE INLET & END	USE SUFFIX "-L"		

ORDERING EXAMPLE WITH BLEEDS AND BOTTOM FEED: **BPA-03-NPSF-303-BL-BF**

**ORDERING INFORMATION & PART NUMBERS
INTERMEDIATE VALVE SECTIONS**

CARBON & STAINLESS STEEL DIVIDER VALVES

- STANDARD FOOTPRINT, STANDARD PRESSURE (3500 PSI)
- ROHS COMPLIANT CLEAR ZINC PLATING (CRS ONLY)
- SUPPLIED WITH ONLY STAINLESS STEEL CAPS AND MOUNTING BOLTS
- SUPPLIED WITH ONLY VITON O-RINGS



ALL VALVES HAVE 1/8-27 NPSF FRONT FACE ALTERNATE OUTLETS. ALL VALVES MAY BE VERTICALLY CROSSPORTED ON THE FRONT OUTLETS. ALL VALVES CAN BE EQUIPPED WITH PERFORMANCE/RESET INDICATORS.

STANDARD PACK: 5 EACH, 316 STAINLESS STEEL: 1 EACH							
SINGLE OUTPUT	PART NUMBER			TWIN OUTPUT	PART NUMBER		
	CRS	303 SS	316 SS		CRS	303 SS	316 SS
.010 CI .164 CC	000-05S	303-05S	316-05S	.005 CI .082 CC	000-05T	303-05T	316-05T
.020 CI .328 CC	000-10S	303-10S	316-10S	.010 CI .164 CC	000-10T	303-10T	316-10T
.030 CI .492 CC	000-15S	303-15S	316-15S	.015 CI .246 CC	000-15T	303-15T	316-15T
.040 CI .656 CC	000-20S	303-20S	316-20S	.020 CI .328 CC	000-20T	303-20T	316-20T
.050 CI .820 CC	000-25S	303-25S	316-25S	.025 CI .410 CC	000-25T	303-25T	316-25T
.060 CI .983 CC	000-30S	303-30S	316-30S	.030 CI .492 CC	000-30T	303-30T	316-30T
.070 CI 1.148 CC	000-35S	303-35S	316-35S	.035 CI .574 CC	000-35T	303-35T	316-35T
.080 CI 1.311 CC	000-40S	303-40S	316-40S	.040 CI .656 CC	000-40T	303-40T	316-40T

- FOR CRS BYPASS VALVE USE PART NUMBER **000-BYPASS**
- FOR 303 SS BYPASS VALVE USE PART NUMBER **303-BYPASS**
- FOR 316 SS BYPASS VALVE USE PART NUMBER **316-BYPASS**

RIGHT & LEFT HAND CYCLE INDICATORS AVAILABLE FOR SIZES 000-15 AND ABOVE



- FOR VALVE WITH RIGHT HAND CYCLE INDICATOR, ADD SUFFIX **RHCIP**
- FOR VALVE WITH LEFT HAND CYCLE INDICATOR, ADD SUFFIX **LHCIP**

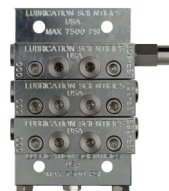

EXAMPLE: 000-25S-RHCIP

ORDERING INFORMATION & PART NUMBERS

STAINLESS STEEL TIE RODS

STAINLESS STEEL TIE RODS

3 TIE RODS REQUIRED PER VALVE ASSEMBLY

ALL TIE RODS INCLUDE ROD NUT
STAINLESS STEEL TIE RODS & NUTS

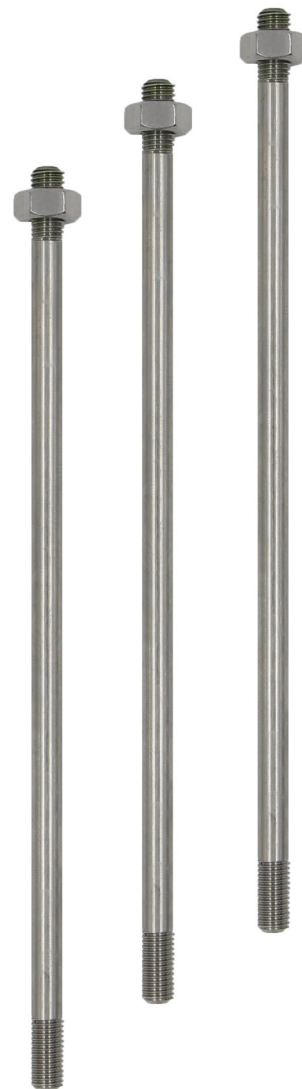

STANDARD PACK: 3 EACH		
PART DESCRIPTION	303 SS	316 SS
3 SECTION VALVE ASSEMBLY	303-TR3	316-TR3
4 SECTION VALVE ASSEMBLY	303-TR4	316-TR4
5 SECTION VALVE ASSEMBLY	303-TR5	316-TR5
6 SECTION VALVE ASSEMBLY	303-TR6	316-TR6
7 SECTION VALVE ASSEMBLY	303-TR7	316-TR7
8 SECTION VALVE ASSEMBLY	303-TR8	316-TR8
9 SECTION VALVE ASSEMBLY	303-TR9	316-TR9
10 SECTION VALVE ASSEMBLY	303-TR10	316-TR10
11 SECTION VALVE ASSEMBLY	303-TR11	316-TR11

ORDERING INFORMATION & PART NUMBERS
SINGLING, CROSSPORTING, & REPLACEMENT PARTS

CROSSPORT BAR KITS

CRS & STAINLESS STEEL CONSTRUCTION WITH
 O-RINGS & MOUNTING BOLTS

STANDARD PACK: 5 EACH			
PART DESCRIPTION	CRS	303 SS	316 SS
CROSSPORT BAR (RIGHT)	L527320	L527320-303	L527320-316
CROSSPORT BAR (LEFT)	L527330	L527330-303	L527330-316
CROSSPORT BAR (BOTH)	L527340	L527340-303	L527340-316

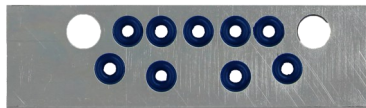

SINGLING BAR KIT

CARBON & STAINLESS STEEL CONSTRUCTION
 WITH VITON O-RINGS

STANDARD PACK: 5 EACH			
DESCRIPTION	CRS	303 SS	316 SS
SINGLING BAR	L527350	L527350-303	L527350-316

REPLACEMENT CLOSURE PLUGS & O-RINGS

STAINLESS STEEL CONSTRUCTION
 O-RINGS INCLUDED



STANDARD PACK: 10 EACH		
PART DESCRIPTION	303 SS	316 SS
ALTERNATE OUTLET (FRONT PORTS) PLUG	A-002-S	A-002-S316
PISTON BORE PLUG	A-001-S	A-001-S316
O-RING SEAL KIT—ALL VALVES/INTERMEDIATES/ENDS	LSP-ORSK	LSP-ORSK

ORDERING INFORMATION & PART NUMBERS

ADDITIONAL ACCESSORIES FOR VERIFYING LUBRICATION SYSTEM FUNCTION

TECHNICAL BULLETINS AVAILABLE FOR ALL ACCESSORIES.

ADDITIONAL DETAILED ACCESSORY INFORMATION LISTED ON PAGE 10-18.

PROXIMITY SWITCH AND CABLES

STANDARD PACK: 1 EACH				
ITEM DESCRIPTION	VALVE ADAPTER	PART NUMBER	MAX PSI / BAR	HAZARD RATING
PROXIMITY SWITCH, 3 PIN MINI-QUICK DISCONNECT	LSP/LHP	L527251	7,500 PSI 517 BAR	NOT RATED
PROXIMITY SWITCH, 4 PIN MINI-QUICK DISCONNECT	LSP/LHP	L527112	7,500 PSI 517 BAR	NOT RATED
PROXIMITY SWITCH, 5 PIN MINI-QUICK DISCONNECT	LSP/LHP	L527111	7,500 PSI 517 BAR	NOT RATED
PROXIMITY SWITCH, EXPLOSION PROOF, 1/2" NPT WITH LEADS	LSP/LHP	L527431	7,500 PSI 517 BAR	CLASS I, GROUPS A,B,C,D CLASS II, GROUPS E,F,G CLASS III



STANDARD PACK: 1 CABLE	
ITEM DESCRIPTION	PART NUMBER
12' 3 PIN CABLE	L527251-CBL12
12' 4 PIN CABLE	L527112-CBL12
12' 5 PIN CABLE	L527111-CBL12

ORDERING INFORMATION & PART NUMBERS

ADDITIONAL ACCESSORIES FOR CUSTOMIZING SYSTEM FUNCTION

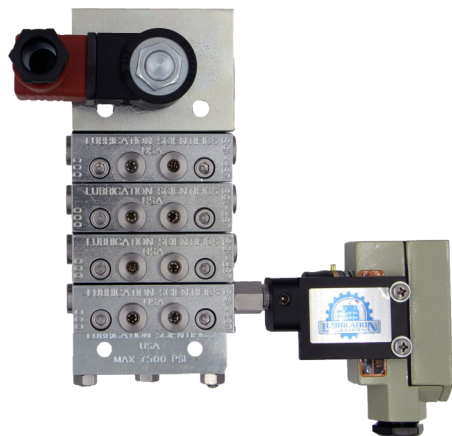

SHUNT INLET VALVES

3 FUNCTION ELECTRIC VALVE
FUNCTION MODES INCLUDE:

- 1) ENTER VALVE
- 2) BYPASS VALVE
- 3) REVERT BACK TO TANK



STANDARD PACK: 1 EACH					
PART DESCRIPTION	POWER INPUT	OPEN/CLOSED	CARBON STEEL	303 STAINLESS	316 STAINLESS
LSP SHUNT INLET	115 VAC	NC	L527660-NC-000	L527660-NC-303	L527660-NC-316
LSP SHUNT INLET	115 VAC	NO	L527660-NO-000	L527660-NO-303	L527660-NO-316
LSP SHUNT INLET	24 VDC	NC	L527680-NC-000	L527680-NC-303	L527680-NC-316
LSP SHUNT INLET	24 VDC	NO	L527680-NO-000	L527680-NO-303	L527680-NO-316

REPLACEMENT COILS

DESCRIPTION	PART NUMBER
24 VDC NORMALLY OPEN WITH PLUG-IN CONNECTOR	L527-24-NO-4823
24 VDC NORMALLY CLOSED WITH PLUG-IN CONNECTOR	L527-24-NC-4823
115 VDC NORMALLY OPEN WITH PLUG-IN CONNECTOR	L527-115-NO-4823
115 VDC NORMALLY CLOSED WITH PLUG-IN CONNECTOR	L527-115-NC-4823



ORDERING INFORMATION & PART NUMBERS

ADDITIONAL ACCESSORIES FOR VERIFYING LUBRICATION SYSTEM FUNCTION OUTLET CHECK VALVES

STANDARD PACK: 5 EACH					
CHECK VALVE DESCRIPTION			PART NUMBER		
INLET SIZE	OUTLET SIZE	BALL OPEN PSI / BAR	303 STAINLESS	316 STAINLESS	ADAPTER REQUIREMENTS
1/8" NPTF (M)	1/4" TUBE	35 / 2.41	OCV-303-125-NPTF	OCV-316-125-NPTF	INTEGRAL FITTING
1/8" ORS (M)	1/4" TUBE	35 / 2.41	OCV-303-125-ORS	OCV-316-125-ORS	INTEGRAL FITTING
1/8" BSPP (M)	6MM TUBE	35 / 2.41	OCV-303-125-BSPP	OCV-316-125-BSPP	INTEGRAL FITTING
M10 X 1.0 ISO (M)	6MM TUBE	35 / 2.41	OCV-303-125-ISO	OCV-316-125-ISO	INTEGRAL FITTING
7/16"-20 SAE (M)	1/4" TUBE	35 / 2.41	OCV-303-125-SAE	OCV-316-125-SAE	INTEGRAL FITTING

STANDARD PACK: 5 EACH					
CHECK VALVE DESCRIPTION			PART NUMBER		
INLET SIZE	OUTLET SIZE	BALL OPEN PSI / BAR	303 STAINLESS	316 STAINLESS	ADAPTER REQUIREMENTS
1/8" NPTF (M)	1/8" NPSF (F)	35 / 2.41	OCV-303-125R-35	OCV-316-125R-35	TUBE FITTING
1/8" NPTF (M)	1/8" NPSF (F)	60 / 4.13	OCV-303-125R-60	OCV-316-125R-60	TUBE FITTING
1/8" NPTF (M)	1/8" NPSF (F)	250 / 17.23	OCV-303-125R-250	OCV-316-125R-250	TUBE FITTING
1/4"NPTF (M)	1/4" NPSF (F)	35 / 2.41	OCV-303-250R-35	OCV-316-250R-35	TUBE FITTING

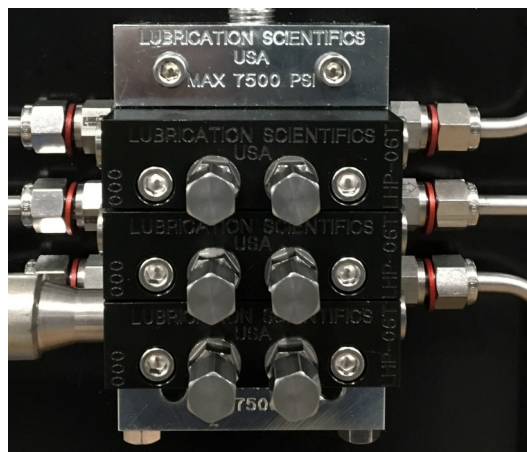

WWW.LUBRICATIONSCIENTIFICS.COM

ORDERING INFORMATION & PART NUMBERS

ADDITIONAL ACCESSORIES FOR VERIFYING LUBRICATION SYSTEM FUNCTION



VISUAL CYCLE INDICATOR



LIMIT SWITCH

STANDARD PACK: 1 EACH	
ITEM DESCRIPTION	PART NUMBER
STAINLESS STEEL VISUAL CYCLE INDICATOR	VCI-437
STAINLESS STEEL VISUAL CYCLE INDICATOR	VCI-437-L LINCOLN® STYLE

STANDARD PACK: 1 EACH	
ITEM DESCRIPTION	PART NUMBER
LIMIT SWITCH ASSEMBLY, SPDT	LSW-001
LIMIT SWITCH ASSEMBLY, DPDT	LSW-002

PERFORMANCE (RESET) INDICATORS

STANDARD PACK: 5 EACH	1/8 NPSF O-RING CONNECTION	
	303 STAINLESS	316 STAINLESS
1,000 PSI 69 BAR	303-P1000	316-P1000
1,500 PSI 103 BAR	303-P1500	316-P1500
2,000 PSI 138 BAR	303-P2000	316-P2000
2,500 PSI 172 BAR	303-P2500	316-P2500
3,000 PSI 207 BAR	303-P3000	316-P3000
3,500 PSI 241 BAR	303-P3500	316-P3500
5,000 PSI 345 BAR	303-P5000	316-P5000
LINCOLN® STYLE INDICATOR ADAPTER	303-PI-ADP-L	316-PI-ADP-L



LINCOLN® IS A REGISTERED TRADEMARK OF LINCOLN®

ORDERING INFORMATION & PART NUMBERS

ADDITIONAL ACCESSORIES FOR VERIFYING LUBRICATION SYSTEM FUNCTION

BLOWOUT FITTINGS

STANDARD PACK: 5 EACH	1/8" O-RING SEAL OR 1/8" NPTF THREADS	
ITEM DESCRIPTION	303 STAINLESS	316 STAINLESS
LOW PRESSURE 1/8" NPSF PLAIN NUT W/ 1/4" APERTURE	BOF-LP-303-NPTF BOF-LP-303-ORS	BOF-LP-316-NPTF BOF-LP-316-ORS
LOW PRESSURE 1/8" NPSF SPUD NUT W/ 1/4" APERTURE	BOF-LP-303R-NPTF BOF-LP-303R-ORS	BOF-LP-316R-NPTF BOF-LP-316R-ORS
HIGH PRESSURE 1/8" NPSF PLAIN NUT W/ 1/8" APERTURE	BOF-HP-303-NPTF BOF-HP-303-ORS	BOF-HP-316-NPTF BOF-HP-316-ORS
HIGH PRESSURE 1/8" NPSF SPUD NUT W/ 1/8" APERTURE	BOF-HP-303R-NPTF BOF-HP-303R-ORS	BOF-HP-316R-NPTF BOF-HP-316R-ORS



NOTE: RUPTURE DISK NOT INCLUDED

3/8" DIAMETER RUPTURE DISKS

STANDARD PACK: 25 EACH			
DISC COLOR	LOW PRESSURE BURST (PSI / BAR) (1/4" APERTURE FITTING)	HIGH PRESSURE BURST (PSI / BAR) (1/8" APERTURE FITTING)	PART NUMBER
BLACK	900 / 62	N/R	A509-276-000
GREEN	1,175 / 81	N/R	A509-277-000
YELLOW	1,450 / 100	3,700 / 255	A509-292-000
RED	1,750 / 121	4,600 / 317	A509-279-000
ORANGE	2,050 / 141	5,500 / 379	A509-280-000
ALUMINUM	2,350 / 162	N/R	A509-281-000
PINK	2,650 / 183	6,400 / 441	A509-282-000
BLUE	2,950 / 203	7,300 / 503	A509-283-000
PURPLE	3,250 / 224	8,200 / 565	A509-284-000

NOTE: ALL DISKS HAVE A RUPTURE TOLERANCE OF +500 PSI

ORDERING INFORMATION & PART NUMBERS

ADDITIONAL ACCESSORIES FOR VERIFYING LUBRICATION SYSTEM FUNCTION

ATMOSPHERIC RESET INDICATORS

PART NUMBER	DESCRIPTION
L5081000-NPTF	ATMOSPHERIC RESET INDICATOR, 1000 PSI, 1/8 NPTF
L5081000-ORS	ATMOSPHERIC RESET INDICATOR, 1000 PSI, 1/8 ORS
L5081500-NPTF	ATMOSPHERIC RESET INDICATOR, 1500 PSI, 1/8 NPTF
L5081500-ORS	ATMOSPHERIC RESET INDICATOR, 1500 PSI, 1/8 ORS
L5082000-NPTF	ATMOSPHERIC RESET INDICATOR, 2000 PSI, 1/8 NPTF
L5082000-ORS	ATMOSPHERIC RESET INDICATOR, 2000 PSI, 1/8 ORS
L5082500-NPTF	ATMOSPHERIC RESET INDICATOR, 2500 PSI, 1/8 NPTF
L5082500-ORS	ATMOSPHERIC RESET INDICATOR, 2500 PSI, 1/8 ORS
L5083000-NPTF	ATMOSPHERIC RESET INDICATOR, 3000 PSI, 1/8 NPTF
L5083000-ORS	ATMOSPHERIC RESET INDICATOR, 3000 PSI, 1/8 ORS
L5081000-316-NPTF	316 ATMOSPHERIC RESET INDICATOR, 1000 PSI, 1/8 NPT
L5081000-316-ORS	316 ATMOSPHERIC RESET INDICATOR, 1000 PSI, 1/8 ORS
L5081500-316-NPTF	316 ATMOSPHERIC RST INDICATOR, 1500 PSI, 1/8 NPTF
L5081500-316-ORS	316 ATMOSPHERIC RESET INDICATOR, 1500 PSI, 1/8 ORS
L5082000-316-NPTF	316 ATMOSPHERIC RST INDICATOR, 2000 PSI, 1/8 NPTF
L5082000-316-ORS	316 ATMOSPHERIC RST INDICATOR, 2000 PSI, 1/8 ORS
L5082500-316-NPTF	316 ATMOSPHERIC RST INDICATOR, 2500 PSI, 1/8 NPTF
L5082500-316-ORS	316 ATMOSPHERIC RST INDICATOR, 2500 PSI, 1/8 ORS
L5083000-316-NPTF	316 ATMOSPHERIC RST INDICATOR, 3000 PSI, 1/8 NPTF
L5083000-316-ORS	316 ATMOSPHERIC RST INDICATOR, 3000 PSI, 1/8 ORS

ORDERING INFORMATION & PART NUMBERS

ADDITIONAL ACCESSORIES FOR VERIFYING LUBRICATION SYSTEM FUNCTION

CONTAMINATION IS THE ENEMY OF RELIABILITY

THE DIRT TRAP IS THE ANSWER

DIRT TRAP FILTER ASSEMBLY



STANDARD PACK: 1 EACH		
FILTER RATING	PLATED CARBON STEEL 7,500 PSI / 517 BAR	AL2024 BLUE ANODIZED ALUMINUM 6,000 PSI / 414 BAR
5 MICRON	DTFA-005-O	MDFA-005-O
10 MICRON	DTFA-010-O	MDFA-010-O
25 MICRON	DTFA-025-O	MDFA-025-O
150 MICRON 100 MESH	DTFA-100-G	MDFA-100-G
420 MICRON 40 MESH	DTFA-040-G	MDFA-040-G

DIRT TRAP REPLACEMENT ELEMENT

STANDARD PACK: 1 EACH	
FILTER RATING	PART NUMBER
5 MICRON	DT-EL-002-005MIC
10 MICRON	DT-EL-002-010MIC
25 MICRON	DT-EL-002-025MIC
150 MICRON 100 MESH	DT-EL-002-100M
420 MICRON 40 MESH	DT-EL-002-40M



NOTE: REPLACEMENT ELEMENTS ARE COMPATIBLE WITH BOTH CARBON STEEL AND 2024 ALUMINUM MODELS.

ORDERING INFORMATION & PART NUMBERS

ADDITIONAL ACCESSORIES FOR VERIFYING LUBRICATION SYSTEM FUNCTION

STANDARD PACK: 5 EACH			
PRODUCT DESCRIPTION	CARBON STEEL	303 STAINLESS STEEL	316 STAINLESS STEEL
4 WAY CROSS 1/8 NPSF (X4) 9/32 MTG HOLE	L509189-000	L509189-303	L509189-316
4 WAY CROSS 1/4 NPSF (X4) 9/32 MTG HOLE	L509188-000	L509188-303	L509188-316
5 WAY CROSS 1/4 NPSF (X4) 1/8 NPSF (X1) 9/32 MTG HOLE	L509190-000	L509190-303	L509190-316
2 WAY STRAIGHT 1/8 NPSF (X2) 9/32 MTG HOLE	L509180-000	L509180-303	L509180-316
2 WAY STRAIGHT 1/4 NPSF (X2) 9/32 MTG HOLE	L509185-000	L509185-303	L509185-316
90 DEGREE ELBOW 1/8 NPSF (X2) 9/32 MTG HOLE	L509170-000	L509170-303	L509170-316
90 DEGREE ELBOW 1/4 NPSF (X2) 9/32 MTG HOLE	L509175-000	L509175-303	L509175-316

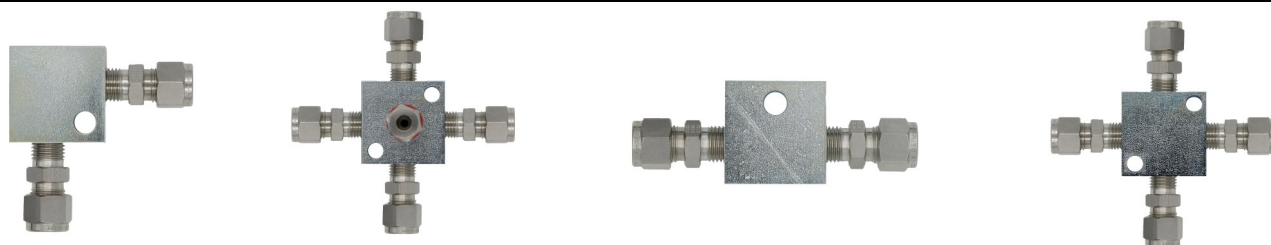

ORDERING INFORMATION & PART NUMBERS

ADDITIONAL ACCESSORIES FOR VERIFYING LUBRICATION SYSTEM FUNCTION

COMPLETE FILTER ASSEMBLY (NO GAUGE)

STANDARD PACK: 1 EACH	
PRODUCT DESCRIPTION	PART NUMBER
FILTER ASSEMBLY (SHORT) 10 MICRONS	CFIL-10-US
FILTER ASSEMBLY (SHORT) 20 MICRONS	CFIL-20-US
FILTER ASSEMBLY (SHORT) 50 MICRONS	CFIL-50-US

NOTE: PRESSURE GAUGES SOLD SEPARATELY

STANDARD PACK: 1 EACH	
PRODUCT DESCRIPTION	PART NUMBER
FILTER ASSEMBLY (LONG) 10 MICRONS	CFIL-10-UL
FILTER ASSEMBLY (LONG) 20 MICRONS	CFIL-20-UL
FILTER ASSEMBLY (LONG) 50 MICRONS	CFIL-50-UL

NOTE: PRESSURE GAUGES SOLD SEPARATELY



REPLACEMENT FILTER ELEMENTS & GAUGE

STANDARD PACK: 1 EACH	
PRODUCT DESCRIPTION	PART NUMBER
FILTER ELEMENT (SHORT) 10 MICRONS	CFIL-10-ES
FILTER ELEMENT (SHORT) 20 MICRONS	CFIL-20-ES
FILTER ELEMENT (SHORT) 50 MICRONS	CFIL-50-ES

STANDARD PACK: 1 EACH	
PRODUCT DESCRIPTION	PART NUMBER
FILTER ELEMENT (LONG) 10 MICRONS	CFIL-10-EL
FILTER ELEMENT (LONG) 20 MICRONS	CFIL-20-EL
FILTER ELEMENT (LONG) 50 MICRONS	CFIL-50-EL

STANDARD PACK: 1 EACH	
GAUGE DESCRIPTION	PART NUMBER
LOWER MOUNT, 1/4 NPTF, 5000 PSI	LM-25-5K-4

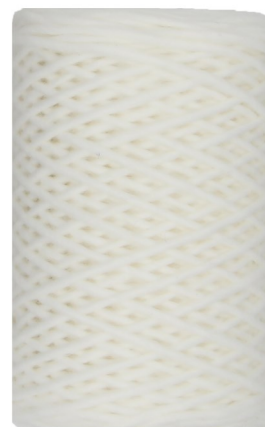

ORDERING INFORMATION & PART NUMBERS

SPIN-ON FILTER ASSEMBLY

ANODIZED ALUMINUM MANIFOLD
 STAINLESS STEEL PRESSURE GAUGES
 MOUNTING BRACKET
 HIGH FLOW FILTER CANISTER
 FOR OIL USE ONLY
 MAX PRESSURE: 150 PSI

STANDARD PACK: 1 EACH	
PART DESCRIPTION	PART NUMBER
SPIN-ON FILTER COMPLETE ASSEMBLY	LPFA-118-AL
REPLACEMENT ELEMENT	LPFA-118-RFE



SPIN-ON FILTER COMPLETE ASSEMBLY



REPLACEMENT ELEMENT

LSP FEEDER PART NUMBER ORDERING GUIDE

LSP-XXX-XXX-XXX-XXX-XXXXX

LSP-XXX-XXX-XXX-XXX-XXXXX	
MATERIAL	P/N
CARBON STEEL	LEAVE BLANK
303 STAINLESS	303
316 STAINLESS	316

LSP-XXX-XXX-XXX-XXX-XXXXX	
PORT OPTIONS	P/N
NPSF PORTS	NPT
1/8 ORS	ORS
SAE PORTS	SAE
BSPP PORTS	BSP
METRIC PORTS	MET

LSP-XXX-XXX-XXX-XXX-XXXXX	
VALVE SIZE	P/N
BYPASS SECTION	BP
.005 CU. IN.	5
.010 CU. IN.	10
.015 CU. IN.	15
.020 CU. IN.	20
.025 CU. IN.	25
.030 CU. IN.	30
.035 CU. IN.	35
.040 CU. IN.	40

LSP-XXX-XXX-XXX-XXX-XXXXX	
INLET SECTION OPTION	P/N
STANDARD	MS
SHUNT 115 VAC, NC TO FEEDER	SHC
SHUNT 115 VAC, NO TO FEEDER	SHO
SHUNT 24 VDC, NC TO FEEDER	SDC
SHUNT 24 VDC, NO TO FEEDER	SDO
ZERO LEAK 115 VAC	ZL
ZERO LEAK 24 VDC	ZF

LSP-XXX-XXX-XXX-XXX-XXXXX	
TYPE OF SECTION	P/N
TWIN	T
SINGLE, RH OUTLET	S
SINGLE, LH OUTLET	L
TWIN, CIP RIGHT	B
SINGLE, CIP RIGHT, RH OUTLET	C
SINGLE, CIP RIGHT, LH OUTLET	D
TWIN, PROXIMITY SWITCH RIGHT	E
SINGLE, PROXIMITY SWITCH RIGHT, RH OUTLET	F
SINGLE, PROXIMITY SWITCH RIGHT, LH OUTLET	G
TWIN, CIP LEFT	H
SINGLE, CIP LEFT, RH OUTLET	J
SINGLE, CIP LEFT, LH OUTLET	K
TWIN, PROXIMITY SWITCH LEFT	M
SINGLE, PROXIMITY SWITCH LEFT, RH OUTLET	N
SINGLE, PROXIMITY SWITCH LEFT, LH OUTLET	P

LSP-XXX-XXX-XXX-XXX-XXXXX	
INSTALLED ACCESSORIES	P/N
NO INTERNAL CHECK VALVES	X
EXTERNAL CHECK VALVES	C
PERFORMANCE INDICATORS	P
PERFORMANCE INDICATORS & CHECK VALVES	B

LSP-XXX-XXX-XXX-XXX-XXXXX	
NUMBER OF SECTIONS	P/N
THREE	3
FOUR	4
FIVE	5
SIX	6
SEVEN	7
EIGHT	8
NINE	9
TEN	10
ELEVEN	11

LSP-XXX-XXX-XXX-XXX-XXXXX	
CROSSPORT OPTION	P/N
RIGHT SIDE	CR
LEFT SIDE	CL
BOTH SIDES	CB

MOUNTING INFORMATION & SPECIFICATIONS

WITH 1.75" STANDARD MOUNTING HOLES

VALVE SECTIONS	A		B	C	D	E
	INCH	mm				
3	3.585/3.605	91.31	1.75	0.490	0.490	0.281
4	4.510/4.530	114.80	1.75	0.490	0.490	0.281
5	5.435/5.455	138.30	1.75	0.490	0.490	0.281
6	6.360/6.380	161.79	1.75	0.490	0.490	0.281
7	7.285/7.305	185.29	1.75	0.490	0.490	0.281
8	8.210/8.230	208.78	1.75	0.490	0.490	0.281

VALVE SECTIONS	NET WEIGHT	
	LBS.	KG.
3	5.9	2.7
4	7.3	3.3
5	8.7	4.0
6	10.2	4.6
7	11.6	5.6
8	13.0	5.9

WITH 1.875" MOUNTING HOLES

VALVE SECTIONS	A		B	C	D	E
	INCH	mm				
3	3.365/3.385	85.72	1.875	0.292	0.310	0.328
4	4.290/4.310	109.22	1.875	0.292	0.310	0.328
5	5.215/5.235	132.71	1.875	0.292	0.310	0.328
6	6.140/6.160	156.21	1.875	0.292	0.310	0.328
7	7.065/7.085	179.70	1.875	0.292	0.310	0.328
8	7.990/8.010	203.20	1.875	0.292	0.310	0.328

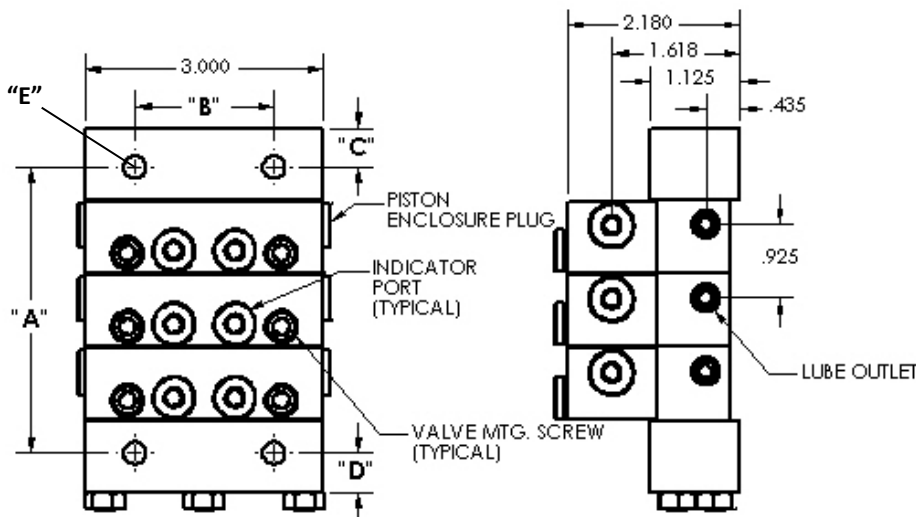
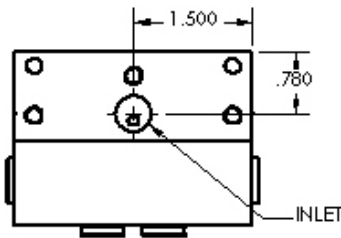

SPECIFICATIONS

MATERIAL: ZINC PLATED STEEL, SS303, SS316

MAX CYCLE RATE (OIL) 200 CPM

MAX PRESSURE: 7500 PSI

TORQUE SPECIFICATIONS

TIE ROD NUT: 5-8 FT/LBS

VALVE MOUNTING BOLTS: 8-9 FT/LBS

ALT. OUTLET PORTS: 8-9 FT/LBS

PISTON CLOSURE PORT: 12-15 FT/LBS

PRODUCT INTERCHANGE—LSP DIVIDER VALVES

LUBRICATION SCIENTIFICS	LUBRIQUIP	GRACO	LINCOLN	FARVAL	PRODUCT DESCRIPTION
000-05S	106-100-015	562711	882051	MCVA250105SG	LSP CRS 05 SINGLE
000-05T	106-100-175	562720	882052	MCVA250105TG	LSP CRS 05 TWIN
000-10S	106-100-025	562712	882101	MCVA250110SG	LSP CRS 10 SINGLE
000-10T	106-100-185	562721	882102	MCVA250110TG	LSP CRS 10 TWIN
000-15S	106-100-035	562713	882151	MCVA250115SG	LSP CRS 15 SINGLE
000-15T	106-100-195	562722	882152	MCVA250115TG	LSP CRS 15 TWIN
000-20S	106-100-045	562714	882201	MCVA250120SG	LSP CRS 20 SINGLE
000-20T	106-100-205	562723	882202	MCVA250120TG	LSP CRS 20 TWIN
000-25S	106-100-055	562715	882251	MCVA250125SG	LSP CRS 25 SINGLE
000-25T	106-100-215	562724	882252	MCVA250125TG	LSP CRS 25 TWIN
000-30S	106-100-065	562716	882301	MCVA250130SG	LSP CRS 30 SINGLE
000-30T	106-100-225	562725	882302	MCVA250130TG	LSP CRS 30 TWIN
000-35S	106-100-075	562717	882351	MCVA250135SG	LSP CRS 35 SINGLE
000-35T	106-100-235	562726	882352	MCVA250135TG	LSP CRS 35 TWIN
000-40S	106-100-085	562718	882401	MCVA250140SG	LSP CRS 40 SINGLE
000-40T	106-100-245	562727	882402	MCVA250140TG	LSP CRS 40 TWIN
000-15S-RHCIP	NA	N/A	N/A	N/A	LSP CRS 15 SGL RHCIP
000-15T-RHCIP	NA	N/A	N/A	N/A	LSP CRS 15 TW RHCIP
000-20S-RHCIP	106-100-735	562729	882203	MCVA250120SPG	LSP CRS 20 SGL RHCIP
000-20T-RHCIP	106-100-935	562739	882204	MCVA250120TPG	LSP CRS 20 TW RHCIP
000-25S-RHCIP	106-100-745	562730	882253	MCVA250125SPG	LSP CRS 25 SGL RHCIP
000-25T-RHCIP	106-100-945	562740	882254	MCVA250125TPG	LSP CRS 25 TW RHCIP
000-30S-RHCIP	106-100-755	562731	882303	MCVA250130SPG	LSP CRS 30 SGL RHCIP
000-30T-RHCIP	106-100-955	562741	882304	MCVA250130TPG	LSP CRS 30 TW RHCIP
000-35S-RHCIP	106-100-765	562732	882353	MCVA250135SPG	LSP CRS 35 SGL RHCIP
000-35T-RHCIP	106-100-965	562742	882354	MCVA250135TPG	LSP CRS 35 TW RHCIP
000-40S-RHCIP	106-100-775	562733	882403	MCVA250140SPG	LSP CRS 40 SGL RHCIP
000-40T-RHCIP	106-100-975	562743	882404	MCVA250140TPG	LSP CRS 40 TW RHCIP
000-15S-LHCIP	N/A	N/A	N/A	N/A	LSP CRS 15 SGL LHCIP
000-15T-LHCIP	N/A	N/A	N/A	N/A	LSP CRS 15 TW LHCIP
000-20S-LHCIP	N/A	562734	N/A	N/A	LSP CRS 20 SGL LHCIP
000-20T-LHCIP	N/A	562744	N/A	N/A	LSP CRS 20 TW LHCIP
000-25S-LHCIP	N/A	562735	N/A	N/A	LSP CRS 25 SGL LHCIP
000-25T-LHCIP	N/A	562745	N/A	N/A	LSP CRS 25 TW LHCIP
000-30S-LHCIP	N/A	562736	N/A	N/A	LSP CRS 30 SGL LHCIP
000-30T-LHCIP	N/A	562746	N/A	N/A	LSP CRS 30 TW LHCIP
000-35S-LHCIP	N/A	562737	N/A	N/A	LSP CRS 35 SGL LHCIP
000-35T-LHCIP	N/A	562747	N/A	N/A	LSP CRS 35 TW LHCIP
000-40S-LHCIP	N/A	562738	N/A	N/A	LSP CRS 40 SGL LHCIP
000-40T-LHCIP	N/A	562748	N/A	N/A	LSP CRS 40 TW LHCIP

*LINCOLN® IS A REGISTERED TRADEMARK OF LINCOLN® INDUSTRIAL

GRACO® IS A REGISTERED TRADEMARK OF GRACO®

TRABON® IS A REGISTERED TRADEMARK OF GRACO®

FARVAL® IS A REGISTERED TRADEMARK OF BIJUR DELIMON INTERNATIONAL

DISCLAIMER: Lubrication Scientifics, LLC assumes no responsibility for errors or omissions which may have occurred. While every effort is made to attain accurate information, it is ultimately the responsibility of the distributor and/or customer to verify the accuracy of the information.

PRODUCT INTERCHANGE—LSP DIVIDER VALVES

LUBRICATION SCIENTIFICS	LUBRIQUIP	GRACO	LINCOLN®	FARVAL	PRODUCT DESCRIPTION
000-INL-US	527-001-800	590919	87918	MCI2504BG	LSP CRS INLET 1/4" NPSF
000-INL-SAE	527003-540	560943	N/A	MCI2504AG	LSP CRS INLET 7/16-20 SAE
000-INL-M	527-003-130	560936	N/A	MCI2504CG	LSP CRS INLET 1/4" -19 BSPP
000-INL-ISO	N/A	560943	N/A	N/A	LSP CRS INLET M10 X 1.0 ISO
600-INL-B	527-000-322	563421	N/A	N/A	LSP CRS INLET 1/4" NPSF WITH BLEED SCREW
600-INL-B-SAE	527-001-900	563422	N/A	N/A	LSP CRS INLET 7/16-20 SAE WITH BLEED SCREW
SEE LS SHUNT INLET FORM	N/A	N/A	N/A	37499A	LSP CRS OIL INLET WITHOUT SOLENOID 7/16-20 SAE INLET
SEE LS SHUNT INLET FORM	N/A	N/A	N/A	37499B	LSP CRS OIL INLET WITHOUT SOLENOID 1/4-18 NPSF INLET
SEE LS SHUNT INLET FORM	N/A	N/A	N/A	37499C	LSP CRS OIL INLET WITHOUT SOLENOID 1/4-19 BSPP INLET
SEE LS SHUNT INLET FORM	N/A	N/A	N/A	37500A	LSP CRS GREASE INLET WITHOUT SOLENOID 7/16-20 SAE INLET
SEE LS SHUNT INLET FORM	N/A	N/A	N/A	37500B	LSP CRS GREASE INLET WITHOUT SOLENOID 1/4-18 NPSF INLET
SEE LS SHUNT INLET FORM	N/A	N/A	N/A	37500C	LSP CRS GREASE INLET WITHOUT SOLENOID 1/4-19 BSPP INLET
SEE LS SHUNT INLET FORM	N/A	N/A	N/A	MCZ2501F	OIL SOLENOID VALVE BELOW 1500 PSI 120VAC
SEE LS SHUNT INLET FORM	N/A	N/A	N/A	MCZ2501A	OIL SOLENOID VALVE 3000 PSI MAX 120 VAC
SEE LS SHUNT INLET FORM	N/A	N/A	N/A	MCZ2503B	GREASE SOLENOID VALVE 3000 PSI MAX 12 VAC
L527330	527-005-330	562470	N/A	37083	LSP CRS CROSSPORT LEFT HAND
L527320	527-005-320	563469	N/A	37083	LSP CRS CROSSPORT RIGHT HAND
L527340	527-005-340	563471	N/A	37083 (2 REQD)	LSP CRS CROSSPORT BOTH
000-BP	106-000-010	562660	882000	MCVA2501BPG	LSP CRS BY-PASS SECTION
L527350	527-005-350	563472	N/A	N/A	LSP CRS SINGLING BAR
000-BP-NPSF	527-000-311	563425	87919	MCBA2502BG	LSP CRS BASE PLATE 1/8-27 NPSF
000-BP-1/8ORS	N/A	N/A	N/A	N/A	LSP CRS BASE PLATE 1/8 WITH O-RING
000-BP-SAE	527-003-550	563451	N/A	MCBA2502AG	LSP CRS BASE PLATE 7/16-20 SAE
000-BP-M	527-003-140	563447	N/A	MCBA2502CG	LSP CRS BASE PLATE 1/8-28 BSPP
000-BP-ISO	N/A	N/A	N/A	N/A	LSP CRS BASE PLATE M10.0 X 1.0 ISO
000-END	527-001-900	563424	87920	MCEA2503G	LSP CRS END PLATE
N/A	510-770-332	563279	N/A	37484	LSP CRS END WITH ALT. INLET 1/8" NPSF
LSP-TRN-SS	410-440-010	556371	N/A	U251A	LSP CRS TIE ROD NUT 1/4"-28 HEX
LSP-ORSK	N/A	N/A	N/A	U1720005S	LSP VALVE AND BASE PLATE O-RINGS VITON
303-TR3	527-001-930	557731	250290	MCRK25053G	LSP CRS 3-SECTION TIE ROD & NUT (PACK OF 3 EACH)
303-TR4	527-001-940	557732	250291	MCRK25054G	LSP CRS 4-SECTION TIE ROD & NUT (PACK OF 3 EACH)
303-TR5	527-001-950	557733	250292	MCRK25055G	LSP CRS 5-SECTION TIE ROD & NUT (PACK OF 3 EACH)
303-TR6	527-001-960	557734	250293	MCRK25056G	LSP CRS 6-SECTION TIE ROD & NUT (PACK OF 3 EACH)
303-TR7	527-001-970	557735	250294	MCRK25057G	LSP CRS 7-SECTION TIE ROD & NUT (PACK OF 3 EACH)
303-TR8	527-001-980	557736	250295	MCRK25058G	LSP CRS 8-SECTION TIE ROD & NUT (PACK OF 3 EACH)
303-TR9	527-001-990	557738	N/A	MCRK25059G	LSP CRS 9-SECTION TIE ROD & NUT (PACK OF 3 EACH)
303-TR10	527-001-910	557739	N/A	MCRK250510G	LSP CRS 10-SECTION TIE ROD & NUT (PACK OF 3 EACH)
303-TR11	N/A	557740	N/A	N/A	LSP CRS 11-SECTION TIE ROD & NUT (PACK OF 3 EACH)
LSP-VMB-303	N/A	N/A	N/A	U212-A6	LSP CRS BASE ASSEMBLY SCREWS 1/4-28
N/A	N/A	N/A	N/A	N/A	CRS ELEMENT SCREWS 1/4-28
N/A	N/A	N/A	N/A	N/A	CRS 1/4-28 THREADED INSERT
A-001-S	527-001-9001-S0	557716	N/A	PLU14038A	LSP CRS PISTON CLOSURE PLUG WITH O-RING
A-002-S	527-001-9002-S0	567251	N/A	U119AC	LSP CRS ALTERNATE OUTLET PLUG WITH O-RING
131-1827PP	503-485-000	557349	68645	N/A	LSP CRS OUTLET PORT PLUG 1/8-20 NPSF
131-1828PP	412-700-404	558799	N/A	N/A	LSP CRS OUTLET PORT PLUG 1/8-28 BSPP
A-0001-S	412-120-206	567251	N/A	N/A	LSP CRS OUTLET PORT PLUG 2-SAE
131-M10PP	N/A	N/A	N/A	N/A	LSP CRS OUTLET PLUG M10 X 1.0 ISO
LSP-CIPMRK	560-002-055	563929	N/A	N/A	LSP CYCLE PIN REPAIR KIT
000-15S-RHCIP	N/A	N/A	N/A	N/A	LSP CRS 15 SGL RHCIP
000-15T-RHCIP	N/A	N/A	N/A	N/A	LSP CRS 15 TW RHCIP
000-20S-RHCIP	106-100-735	562729	882203	MCVA250120SPG	LSP CRS 20 SGL RHCIP
000-20T-RHCIP	106-100-935	562739	882204	MCVA250120TPG	LSP CRS 20 TW RHCIP
000-25S-RHCIP	106-100-745	562730	882253	MCVA250125SPG	LSP CRS 25 SGL RHCIP
000-25T-RHCIP	106-100-945	562740	882254	MCVA250125TPG	LSP CRS 25 TW RHCIP
000-30S-RHCIP	106-100-755	562731	882303	MCVA250130SPG	LSP CRS 30 SGL RHCIP
000-30T-RHCIP	106-100-955	562741	882304	MCVA250130TPG	LSP CRS 30 TW RHCIP
000-35S-RHCIP	106-100-765	562732	882353	MCVA250135SPG	LSP CRS 35 SGL RHCIP
000-35T-RHCIP	106-100-965	562742	882354	MCVA250135TPG	LSP CRS 35 TW RHCIP
000-40S-RHCIP	106-100-775	562733	882403	MCVA250140SPG	LSP CRS 40 SGL RHCIP
000-40T-RHCIP	106-100-975	562743	882404	MCVA250140TPG	LSP CRS 40 TW RHCIP
000-20S-LHCIP	106-100-785	562734	N/A	N/A	LSP CRS 20 SGL LHCIP
000-20T-LHCIP	106-100-985	562744	N/A	N/A	LSP CRS 20 TW LHCIP

PRODUCT INTERCHANGE—LSP DIVIDER VALVES

LUBRICATION SCIENTIFICS	LUBRIQUIP	GRACO	LINCOLN®	FARVAL	PRODUCT DESCRIPTION
000-25S-LHCIP	106-100-795	562735	N/A	N/A	LSP CRS 25 SGL LHCIP
000-25T-LHCIP	106-100-995	562745	N/A	N/A	LSP CRS 25 TW LHCIP
000-30S-LHCIP	106-100-805	562736	N/A	N/A	LSP CRS 30 SGL LHCIP
000-30T-LHCIP	106-101-005	562746	N/A	N/A	LSP CRS 30 TW LHCIP
000-35S-LHCIP	106-100-815	562737	N/A	N/A	LSP CRS 35 SGL LHCIP
000-35T-LHCIP	106-101-015	562747	N/A	N/A	LSP CRS 35 TW LHCIP
000-40S-LHCIP	106-100-825	562738	N/A	N/A	LSP CRS 40 SGL LHCIP
000-40T-LHCIP	106-101-025	562748	N/A	N/A	LSP CRS 40 TW LHCIP
LSW-001	510-599-000	563272	87070	N/A	LSP CYCLE SWITCH SPDT
LSW-002	510-577-000	564357	N/A	MC13974B	LSP CYCLE SWITCH DPDT
SEE PROX BULLETIN	527-001-231	563427	85651	N/A	LSP REED SWITCH SPST
SEE PROX BULLETIN	527-003-431	557745	249124	MCSA2503	LSP HALL EFFECT PROX SWITCH SPDT
SEE PROX BULLETIN	N/A	N/A	N/A	N/A	LSP 6' 3-PIN CABLE
SEE PROX BULLETIN	527-006-060	563485	N/A	N/A	LSP HALL EFFECT PROX SWITCH SPST EXPLOSION PROOF
VCI-437	N/A	N/A	N/A	37786	LSP VISUAL INDICATOR
000-INL-US	527-001-800	590919	87918	N/A	LSP CRS INLET 1/4" NPSF
LSW-001	510-599-000	563272	N/A	N/A	LSP CYCLE SWITCH SPDT
LSW-002	510-577-000	564357	N/A	N/A	LSP CYCLE SWITCH DPDT
SEE PROX BULLETIN	527-001-231	563427	N/A	N/A	LSP REED SWITCH SPST
SEE PROX BULLETIN	527-003-431	557745	N/A	N/A	LSP HALL EFFECT PROX SWITCH SDST
SEE PROX BULLETIN	?	?	N/A	N/A	LSP 6' 3-PIN CABLE
SEE PROX BULLETIN	527-006-060	563485	N/A	N/A	LSP HALL EFFECT PROX SWITCH SPST EXPLOSION PROOF
303-INL-US	N/A	15Y070	N/A	N/A	LSP 303 INLET 1/4" NPSF
303-INL-SAE	N/A	N/A	N/A	N/A	LSP 303 INLET 7/16-20 SAE
303-INL-M	N/A	16P368	N/A	N/A	LSP 303 INLET 1/4" -19 BSPP
303-INL-ISO	N/A	N/A	N/A	N/A	LSP 303 INLET M10 X 1.0 ISO
603-INL-B	N/A	N/A	N/A	N/A	LSP 303 INLET 1/4" NPSF WITH BLEED SCREW
603-INL-B-SAE	N/A	N/A	N/A	N/A	LSP 303 INLET 7/16-20 SAE WITH BLEED SCREW
L527330	N/A	N/A	N/A	N/A	LSP 303 CROSSPORT PLATE LEFT HAND
L527320	N/A	N/A	N/A	N/A	LSP 303 CROSSPORT PLATE RIGHT HAND
L527340	N/A	N/A	N/A	N/A	LSP 303 CROSSPORT PLATE BOTH
303-BP	N/A	N/A	N/A	N/A	LSP 303 BY-PASS SECTION
L527350-303	N/A	N/A	N/A	N/A	LSP 303 SINGLING PLATE
303-BP-NPSF	N/A	24B497	N/A	N/A	LSP 303 BASE PLATE 1/8-27 NPSF
303-BP-1/8ORS	N/A	N/A	N/A	N/A	LSP 303 BASE PLATE 1/8 WITH O-RING
303-BP-SAE	N/A	N/A	N/A	N/A	LSP 303 BASE PLATE 7/16-20 SAE
303-BP-M	N/A	24N369	N/A	N/A	LSP 303 BASE PLATE 1/8-28 BSPP
303-BP-ISO	N/A	N/A	N/A	N/A	LSP 303 BASE PLATE M10.0 X 1.0 ISO
303-END	N/A	24B498	N/A	N/A	LSP 303 END PLATE
603-END	N/A	N/A	N/A	N/A	LSP 303 END WITH ALT. INLET 1/8" NPSF
LSP-TRN-SS	N/A	558633	N/A	N/A	LSP 303 TIE ROD NUT 1/4"-28 HEX
303-TR3	N/A	126247	N/A	N/A	LSP 303 3-SECTION TIE ROD & NUT (PACK OF 3 EACH)
303-TR4	N/A	126248	N/A	N/A	LSP 303 4-SECTION TIE ROD & NUT (PACK OF 3 EACH)
303-TR5	N/A	126249	N/A	N/A	LSP 303 5-SECTION TIE ROD & NUT (PACK OF 3 EACH)
303-TR6	N/A	126250	N/A	N/A	LSP 303 6-SECTION TIE ROD & NUT (PACK OF 3 EACH)
303-TR7	N/A	126251	N/A	N/A	LSP 303 7-SECTION TIE ROD & NUT (PACK OF 3 EACH)
303-TR8	N/A	126252	N/A	N/A	LSP 303 8-SECTION TIE ROD & NUT (PACK OF 3 EACH)
303-TR9	N/A	15Y069	N/A	N/A	LSP 303 9-SECTION TIE ROD & NUT (PACK OF 3 EACH)
303-TR10	N/A	560956	N/A	N/A	LSP 303 10-SECTION TIE ROD & NUT (PACK OF 3 EACH)
303-TR11	N/A	N/A	N/A	N/A	LSP 303 11-SECTION TIE ROD & NUT (PACK OF 3 EACH)
A-001-S	N/A	560973	N/A	N/A	LSP 303 PISTON CLOSURE PLUG WITH O-RING
A-002-S	N/A	N/A	N/A	N/A	LSP 303 ALTERNATE OUTLET PLUG WITH O-RING
131-1827PP	N/A	560974	N/A	N/A	LSP 303 OUTLET PORT PLUG 1/8-20 NPSF
131-1828PP	N/A	N/A	N/A	N/A	LSP 303 OUTLET PORT PLUG 1/8-28 BSPP
A-0001-S	N/A	N/A	N/A	N/A	LSP 303 OUTLET PORT PLUG 2-SAE
131-M10PP	N/A	N/A	N/A	N/A	LSP 303 OUTLET PLUG M10 X 1.0 ISO
303-05S	N/A	24B474	N/A	N/A	LSP 303 05 SINGLE
303-05T	N/A	24B479	N/A	N/A	LSP 303 05 TWIN
303-10S	N/A	562755	N/A	N/A	LSP 303 10 SINGLE
303-10T	N/A	562758	N/A	N/A	LSP 303 10 TWIN
303-15S	N/A	24B475	N/A	N/A	LSP 303 15 SINGLE
303-15T	N/A	24B480	N/A	N/A	LSP 303 15 TWIN

PRODUCT INTERCHANGE—LSP DIVIDER VALVES

LUBRICATION SCIENTIFICS	LUBRIQUIP	GRACO	LINCOLN®	FARVAL	PRODUCT DESCRIPTION
303-20S	N/A	562756	N/A	N/A	LSP 303 20 SINGLE
303-20T	N/A	562759	N/A	N/A	LSP 303 20 TWIN
303-25S	N/A	24B476	N/A	N/A	LSP 303 25 SINGLE
303-25T	N/A	24B481	N/A	N/A	LSP 303 25 TWIN
303-30S	N/A	24B477	N/A	N/A	LSP 303 30 SINGLE
303-30T	N/A	24B482	N/A	N/A	LSP 303 30 TWIN
303-35S	N/A	24B478	N/A	N/A	LSP 303 35 SINGLE
303-35T	N/A	24B483	N/A	N/A	LSP 303 35 TWIN
303-40S	N/A	562757	N/A	N/A	LSP 303 40 SINGLE
303-40T	N/A	562760	N/A	N/A	LSP 303 40 TWIN
303-15S-RHCIP	N/A	N/A	N/A	N/A	LSP 303 15 SGL RHCIP
303-15T-RHCIP	N/A	N/A	N/A	N/A	LSP 303 15 TW RHCIP
303-20S-RHCIP	N/A	N/A	N/A	N/A	LSP 303 20 SGL RHCIP
303-20T-RHCIP	N/A	N/A	N/A	N/A	LSP 303 20 TW RHCIP
303-25S-RHCIP	N/A	N/A	N/A	N/A	LSP 303 25 SGL RHCIP
303-25T-RHCIP	N/A	N/A	N/A	N/A	LSP 303 25 TW RHCIP
303-30S-RHCIP	N/A	N/A	N/A	N/A	LSP 303 30 SGL RHCIP
303-30T-RHCIP	N/A	N/A	N/A	N/A	LSP 303 30 TW RHCIP
303-35S-RHCIP	N/A	N/A	N/A	N/A	LSP 303 35 SGL RHCIP
303-35T-RHCIP	N/A	N/A	N/A	N/A	LSP 303 35 TW RHCIP
303-40S-RHCIP	N/A	N/A	N/A	N/A	LSP 303 40 SGL RHCIP
303-40T-RHCIP	N/A	N/A	N/A	N/A	LSP 303 40 TW RHCIP
303-15S-LHCIP	N/A	N/A	N/A	N/A	LSP 303 15 SGL LHCIP
303-15T-LHCIP	N/A	N/A	N/A	N/A	LSP 303 15 TW LHCIP
303-20S-LHCIP	N/A	N/A	N/A	N/A	LSP 303 20 SGL LHCIP
303-20T-LHCIP	N/A	N/A	N/A	N/A	LSP 303 20 TW LHCIP
303-25S-LHCIP	N/A	N/A	N/A	N/A	LSP 303 25 SGL LHCIP
303-25T-LHCIP	N/A	N/A	N/A	N/A	LSP 303 25 TW LHCIP
303-30S-LHCIP	N/A	N/A	N/A	N/A	LSP 303 30 SGL LHCIP
303-30T-LHCIP	N/A	N/A	N/A	N/A	LSP 303 30 TW LHCIP
303-35S-LHCIP	N/A	N/A	N/A	N/A	LSP 303 35 SGL LHCIP
303-35T-LHCIP	N/A	N/A	N/A	N/A	LSP 303 35 TW LHCIP
303-40S-LHCIP	N/A	N/A	N/A	N/A	LSP 303 40 SGL LHCIP
303-40T-LHCIP	N/A	N/A	N/A	N/A	LSP 303 40 TW LHCIP
SEE PROX BULLETIN	527-003-431	557745	N/A	N/A	LSP HALL EFFECT PROX SWITCH SPST
316-INL-US	N/A	N/A	N/A	N/A	LSP 316 INLET 1/4" NPSF
316-INL-SAE	N/A	N/A	N/A	N/A	LSP 316 INLET 7/16-20 SAE
316-INL-M	N/A	N/A	N/A	N/A	LSP 316 INLET 1/4" -19 BSPP
316-INL-ISO	N/A	N/A	N/A	N/A	LSP 316 INLET M10 X 1.0 ISO
616-INL-B	N/A	N/A	N/A	N/A	LSP 316 INLET 1/4" NPSF WITH BLEED SCREW
616-INL-B-SAE	N/A	N/A	N/A	N/A	LSP 316 INLET 7/16-20 SAE WITH BLEED SCREW
L527330	N/A	N/A	N/A	N/A	LSP 316 CROSSPORT PLATE LEFT HAND
L527320	N/A	N/A	N/A	N/A	LSP 316 CROSSPORT PLATE RIGHT HAND
L527340	N/A	N/A	N/A	N/A	LSP 316 CROSSPORT PLATE BOTH
316-BP	N/A	N/A	N/A	N/A	LSP 316 BY-PASS SECTION
L527350-316	N/A	N/A	N/A	N/A	LSP 316 SINGLING PLATE
316-BP-NPSF	N/A	N/A	N/A	N/A	LSP 316 BASE PLATE 1/8-27 NPSF
316-BP-1/8ORS	N/A	N/A	N/A	N/A	LSP 316 BASE PLATE 1/8 WITH O-RING
316-BP-SAE	N/A	N/A	N/A	N/A	LSP 316 BASE PLATE 7/16-20 SAE
316-BP-M	N/A	N/A	N/A	N/A	LSP 316 BASE PLATE 1/8-28 BSPP
316-BP-ISO	N/A	N/A	N/A	N/A	LSP 316 BASE PLATE M10.0 X 1.0 ISO
316-END	N/A	N/A	N/A	N/A	LSP 316 END PLATE
616-END	N/A	N/A	N/A	N/A	LSP 316 END WITH ALT. INLET 1/8" NPSF
LSP-TRN-316	N/A	N/A	N/A	N/A	LSP 316 TIE ROD NUT 1/4"-28 HEX
316-TR3	N/A	N/A	N/A	N/A	LSP 316 3-SECTION TIE ROD & NUT (PACK OF 3 EACH)
316-TR4	N/A	N/A	N/A	N/A	LSP 316 4-SECTION TIE ROD & NUT (PACK OF 3 EACH)
316-TR5	N/A	N/A	N/A	N/A	LSP 316 5-SECTION TIE ROD & NUT (PACK OF 3 EACH)
316-TR6	N/A	N/A	N/A	N/A	LSP 316 6-SECTION TIE ROD & NUT (PACK OF 3 EACH)
316-TR7	N/A	N/A	N/A	N/A	LSP 316 7-SECTION TIE ROD & NUT (PACK OF 3 EACH)
316-TR8	N/A	N/A	N/A	N/A	LSP 316 8-SECTION TIE ROD & NUT (PACK OF 3 EACH)

PRODUCT INTERCHANGE—LSP DIVIDER VALVES

LUBRICATION SCIENTIFICS	LUBRIQUIP	GRACO	LINCOLN®	FARVAL	PRODUCT DESCRIPTION
316-TR9	N/A	N/A	N/A	N/A	LSP 316 9-SECTION TIE ROD & NUT (PACK OF 3 EACH)
316-TR10	N/A	N/A	N/A	N/A	LSP 316 10-SECTION TIE ROD & NUT (PACK OF 3 EACH)
316-TR11	N/A	N/A	N/A	N/A	LSP 316 11-SECTION TIE ROD & NUT (PACK OF 3 EACH)
A-001-S	N/A	N/A	N/A	N/A	LSP 316 PISTON CLOSURE PLUG WITH O-RING
A-002-S	N/A	N/A	N/A	N/A	LSP 316 ALTERNATE OUTLET PLUG WITH O-RING
131-1827PP	N/A	N/A	N/A	N/A	LSP 316 OUTLET PORT PLUG 1/8-20 NPSF
131-1828PP	N/A	N/A	N/A	N/A	LSP 316 OUTLET PORT PLUG 1/8-28 BSPP
A-0001S	N/A	N/A	N/A	N/A	LSP 316 OUTLET PORT PLUG 2-SAE
131-M10PP	N/A	N/A	N/A	N/A	LSP 316 OUTLET PLUG M10 X 1.0 ISO
316-05S	N/A	N/A	N/A	N/A	LSP 316 05 SINGLE
316-05T	N/A	N/A	N/A	N/A	LSP 316 05 TWIN
316-10S	N/A	N/A	N/A	N/A	LSP 316 10 SINGLE
316-10T	N/A	N/A	N/A	N/A	LSP 316 10 TWIN
316-15S	N/A	N/A	N/A	N/A	LSP 316 15 SINGLE
316-15T	N/A	N/A	N/A	N/A	LSP 316 15 TWIN
316-20S	N/A	N/A	N/A	N/A	LSP 316 20 SINGLE
316-20T	N/A	N/A	N/A	N/A	LSP 316 20 TWIN
316-25S	N/A	N/A	N/A	N/A	LSP 316 25 SINGLE
316-25T	N/A	N/A	N/A	N/A	LSP 316 25 TWIN
316-30S	N/A	N/A	N/A	N/A	LSP 316 30 SINGLE
316-30T	N/A	N/A	N/A	N/A	LSP 316 30 TWIN
316-35S	N/A	N/A	N/A	N/A	LSP 316 35 SINGLE
316-35T	N/A	N/A	N/A	N/A	LSP 316 35 TWIN
316-40S	N/A	N/A	N/A	N/A	LSP 316 40 SINGLE
316-40T	N/A	N/A	N/A	N/A	LSP 316 40 TWIN
316-15S-RHCIP	N/A	N/A	N/A	N/A	LSP 316 15 SGL RHCIP
316-15T-RHCIP	N/A	N/A	N/A	N/A	LSP 316 15 TW RHCIP
316-20S-RHCIP	N/A	N/A	N/A	N/A	LSP 316 20 SGL RHCIP
316-20T-RHCIP	N/A	N/A	N/A	N/A	LSP 316 20 TW RHCIP
316-25S-RHCIP	N/A	N/A	N/A	N/A	LSP 316 25 SGL RHCIP
316-25T-RHCIP	N/A	N/A	N/A	N/A	LSP 316 25 TW RHCIP
316-30S-RHCIP	N/A	N/A	N/A	N/A	LSP 316 30 SGL RHCIP
316-30T-RHCIP	N/A	N/A	N/A	N/A	LSP 316 30 TW RHCIP
316-35S-RHCIP	N/A	N/A	N/A	N/A	LSP 316 35 SGL RHCIP
316-35T-RHCIP	N/A	N/A	N/A	N/A	LSP 316 35 TW RHCIP
316-40S-RHCIP	N/A	N/A	N/A	N/A	LSP 316 40 SGL RHCIP
316-40T-RHCIP	N/A	N/A	N/A	N/A	LSP 316 40 TW RHCIP
316-15S-LHCIP	N/A	N/A	N/A	N/A	LSP 316 15 SGL LHCIP
316-15T-LHCIP	N/A	N/A	N/A	N/A	LSP 316 15 TW LHCIP
316-20S-LHCIP	N/A	N/A	N/A	N/A	LSP 316 20 SGL LHCIP
316-20T-LHCIP	N/A	N/A	N/A	N/A	LSP 316 20 TW LHCIP
316-25S-LHCIP	N/A	N/A	N/A	N/A	LSP 316 25 SGL LHCIP
316-25T-LHCIP	N/A	N/A	N/A	N/A	LSP 316 25 TW LHCIP
316-30S-LHCIP	N/A	N/A	N/A	N/A	LSP 316 30 SGL LHCIP
316-30T-LHCIP	N/A	N/A	N/A	N/A	LSP 316 30 TW LHCIP
316-35S-LHCIP	N/A	N/A	N/A	N/A	LSP 316 35 SGL LHCIP
316-35T-LHCIP	N/A	N/A	N/A	N/A	LSP 316 35 TW LHCIP
316-40S-LHCIP	N/A	N/A	N/A	N/A	LSP 316 40 SGL LHCIP
316-40T-LHCIP	N/A	N/A	N/A	N/A	LSP 316 40 TW LHCIP

CONTACT US

IN THE USA, FIND YOUR STATE IN THE MAP BELOW, LOOK FOR THE REGION ID NUMBER AND FIND THAT NUMBER IN THE CONTACT INFORMATION CHART.



1	Call Factory Direct - 877-452-0157	7	Richard Hanley - California - Santa Barbara, Ventura, Los Angeles, Orange, San Bernardino, Riverside, San Diego and Imperial Counties. Nevada - Clark County. Cell: 714-625-5539 Email: rth@lubricationscientifics.com
2	Call Factory Direct - 877-452-0157	8	California - All Counties not covered by Richard. Nevada - All Counties except Clark County. Call Factory Direct - 877-452-0157
3	Call Factory Direct - 877-452-0157		
4	Andy Kromer Cell: 440-364-4721 Email: aklub@lubricationscientifics.com	9	Call Factory Direct - 877-452-0157
5	Call Factory Direct - 877-452-0157	10	Call Factory Direct - 877-452-0157
6	Cory Walker Cell: 832-585-7065 Email: c.walker@lubricationscientifics.com		

Outside of the United States	Call Factory Direct - 877-452-0157
------------------------------	------------------------------------

Customer Service (877-452-0157)

- ◆ Order status & order entry
- ◆ Pricing inquiries
- ◆ Part number look-ups
- ◆ Product availability information
- ◆ Shipment assistance
- ◆ All other general inquires

www.lubricationscientifics.com

- ◆ Product information, specifications, literature
- ◆ Locate sales reps and distributors
- ◆ Operator & Repair manuals
- ◆ Distributer Information
- ◆ Place orders and check current pricing
- ◆ Product Pricing

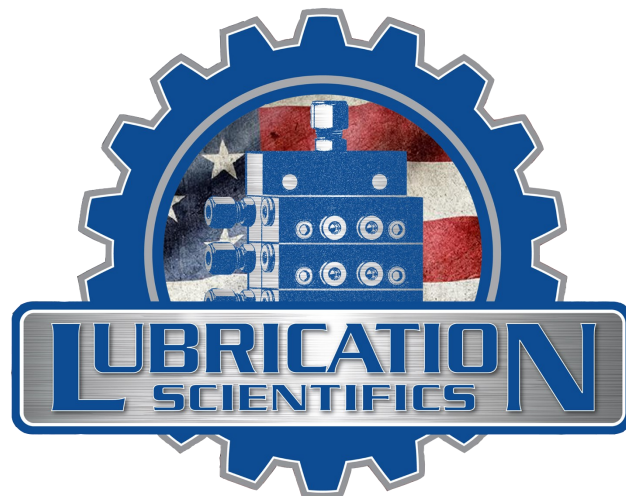

LUBRICATION SCIENTIFICS, LLC

17651 ARMSTRONG AVE.

IRVINE, CA 92614

UNITED STATES OF AMERICA

TOLL FREE TEL: (877) 452-0157, LOCAL TEL: (714) 557-0664, FAX: (714) 546-4564

WWW.LUBRICATIONSCIENTIFICS.COM