



REPLACEMENT PUMP ELEMENTS FOR COMPETITOR ELECTRIC PUMPS

DESMODROMIC DRIVE UNITS (LDPE SERIES)

PUMP ELEMENTS WITH MECHANICALLY CONTROLLED SUCTION AND PRESSURE STROKE

BEKA® MAX REPLACEMENT ELEMENT DESCRIPTION	LUBRICATION SCIENTIFICS PART NUMBER	COMPETITOR PART NUMBER	OUTPUT PER STROKE (cc) (in ³)
REPLACEMENT PUMP ELEMENT - 6MM STANDARD	LDPE-120	PE-120	.120cc .007in ³
REPLACEMENT PUMP ELEMENT - 7MM STANDARD	LDPE-170	PE-170	.170cc .010in ³
REPLACEMENT PUMP ELEMENT - 7MM CHISEL PASTE	LDPE-170-C7	N/A	.170cc .010in ³
REPLACEMENT PUMP ELEMENT - 10MM STANDARD	LDPE-340	N/A	.340cc .020in ³



LDPE-120



LDPE-170 & LDPE-170-C7

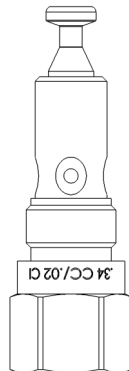

LDPE-340

OUR EXCLUSIVE HARDENED BODY OUTPERFORMS IN SOLID CONTENT GREASES

(GRAPHITE, MOLYBDENUM, etc.)

THE INDUSTRY'S ONLY AVAILABLE 10MM PUMP ELEMENT. (DOUBLE THE OUTPUT OF PE-170)



LDPE REPLACEMENTS SHIPPED WITH BRASS SEAL RING

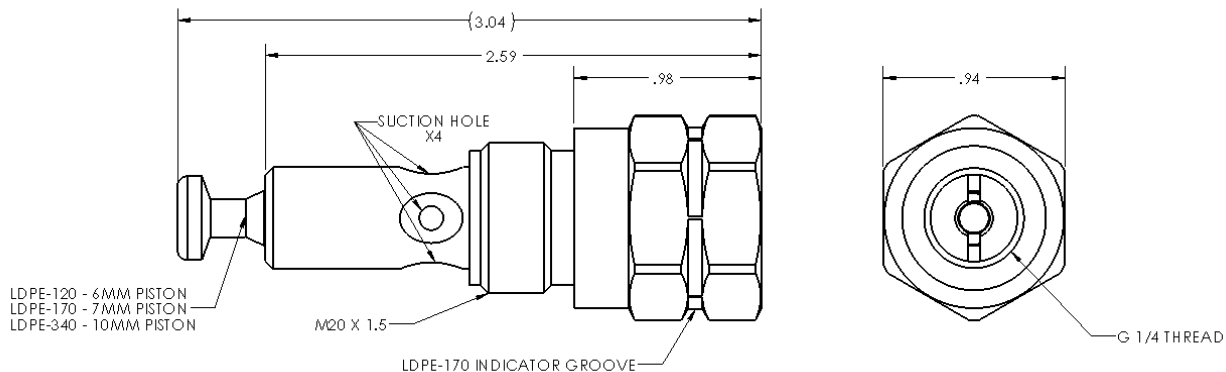

LINCOLN® IS A REGISTERED TRADEMARK OF LINCOLN® INDUSTRIAL

BEKA® IS A REGISTERED TRADEMARK OF BEKA-LUBE PRODUCTS INC.

WWW.LUBRICATIONSCIENTIFICS.COM



REPLACEMENT PUMP ELEMENTS FOR COMPETITOR ELECTRIC PUMPS

LINCOLN®/SKF® REPLACEMENT SPRING RETURN UNITS PUMPING ELEMENTS WITH SPRING RETURN

LINCOLN/SKF® REPLACEMENT ELEMENT DESCRIPTION	LUBRICATION SCIENTIFICS PART NUMBER	COMPETITOR PART NUMBER	OUTPUT PER MIN (cc) (in ³)
REPLACEMENT PUMP ELEMENT - 203 SERIES, 5MM STD	L9203-K5	600-26875-2	2cc .122in ³
REPLACEMENT PUMP ELEMENT - 203 SERIES, 6MM STD	L9203-K6	600-26876-2	2.8cc .171in ³
REPLACEMENT PUMP ELEMENT - 203 SERIES, 7MM STD	L9203-K7	600-26877-2	4cc .244in ³
REPLACEMENT PUMP ELEMENT - 203 SERIES, 7MM CHISEL PASTE	L9203-C7	600-28750-1	4cc .244in ³
REPLACEMENT PUMP ELEMENT - 653 SERIES, 7MM STD	L9653-Z7	645-77196-1	4cc .244in ³
REPLACEMENT PUMP ELEMENT - 653 SERIES, 7MM CHISEL PASTE	L9653-C7	N/A	4cc .244in ³

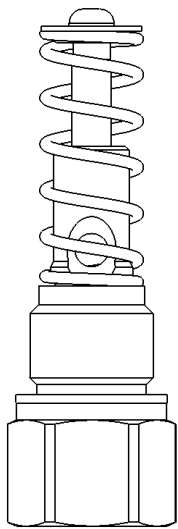

L9203-K5

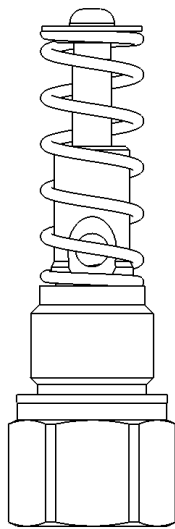

L9203-K6

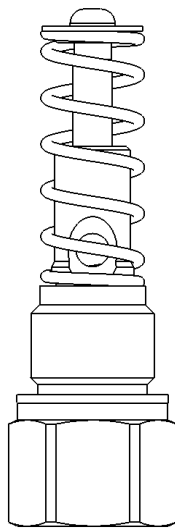

L9203-K7
L9203-C7



L9653-Z7
L9653-C7

**OUR EXCLUSIVE HARDENED BODY
OUTPERFORMS IN SOLID CONTENT
GREASES
(GRAPHITE, MOLYBDENUM, etc.)**

PTFE SEAL WASHER INCLUDED
WITH L9203 SERIES ELEMENTS

VITON O-RINGS INCLUDED
WITH L9653 SERIES ELEMENTS

**GRACO® REPLACEMENT SPRING RETURN UNITS
PUMPING ELEMENTS WITH SPRING RETURN**

GRACO® REPLACEMENT ELEMENT DESCRIPTION	LUBRICATION SCIENTIFICS PART NUMBER	COMPETITOR PART NUMBER	OUTPUT PER MINUTE (cc) (in ³)
REPLACEMENT PUMP ELEMENT - 6.7MM STD	L91041	571041	4cc .247in ³
REPLACEMENT PUMP ELEMENT - 6.7MM CHISEL PASTE	L91041-C7	N/A	4cc .247in ³

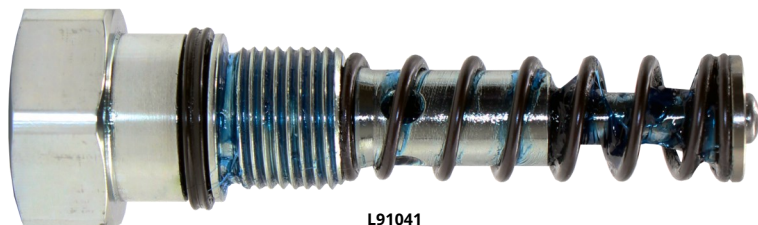

L91041
L91041-C7
VITON SEAL RING INCLUDED



KITS INCLUDES ADJUSTMENT CLIPS

OUR EXCLUSIVE HARDENED BODY OUTPERFORMS IN SOLID CONTENT GREASES (GRAPHITE, MOLYBDENUM, etc.)

PRV'S

REPLACEMENT ELEMENT DESCRIPTION FITS BOTH LINCOLN® AND BEKA® PUMP ELEMENTS	LUBRICATION SCIENTIFICS PART NUMBER	COMPETITOR PART NUMBER
PRESSURE RELIEF VALVE 6MM TUBE NUT/FERRULE OUTLET	LDPE-PRV-LS-6MM	N/A
PRESSURE RELIEF VALVE 1/4 TUBE NUT/FERRULE OUTLET	LDPE-PRV-LS-25US	N/A
REPL PRV (6MM TUBE NUT) FITS BEKA-MAX®/LINCOLN®	LDPE-PRV-STD	DBV

1) SIDE PORTS, (2)
MAY BE USED FOR:

- A) ALTERNATE OUTLET
- B) CROSS PORT CONNECTION
- C) MEMORY INDICATOR
- D) HIGH PRESSURE SWITCH
- E) MANUAL LUBE FILL STUD

2) TAPPED RELIEF PORT, (1)
MAY BE USED FOR:

- A) RETURN TO RESERVOIR

3) BOTTOM PORT, (1)
MAY BE USED FOR:

- A) OUTLET CONNECTION (6MM OR 1/4 TUBE AVAILABLE)
- B) CROSS PORT CONNECTION

4) FRONT PORT, (1)
MAY BE USED FOR:

- A) GAUGE PORT
- B) MANUAL LUBE FILL STUD
- C) ALTERNATE OUTLET

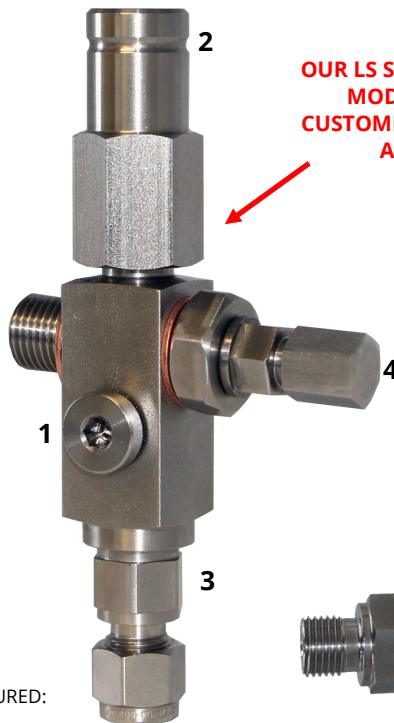

OUR LS SERIES PRVs ARE FULLY MODULAR TO ENABLE CUSTOMIZATION TAILORED TO ANY SITUATION

PICTURED:

LDPE-PRV-LS-6MM
LDPE-PRV-LS-25US

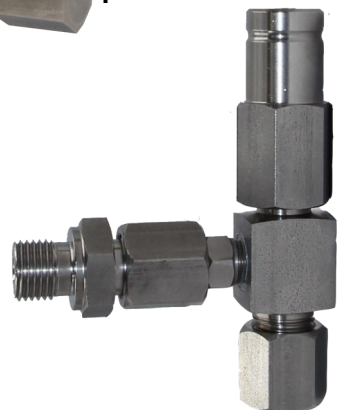

LDPE-PRV-STD

GRACO® IS A REGISTERED TRADEMARK OF GRACO INC.

CONTACT US

IN THE USA, FIND YOUR STATE IN THE MAP BELOW, LOOK FOR THE REGION ID NUMBER AND FIND THAT NUMBER IN THE CONTACT INFORMATION CHART.



CONTACT INFORMATION CHART

1	Call Factory Direct - 877-452-0157	7	Richard Hanley - California - Santa Barbara, Ventura, Los Angeles, Orange, San Bernardino, Riverside, San Diego and Imperial Counties. Nevada - Clark County. Cell: 714-625-5539 Email: rth@lubricationscientifics.com
2	Call Factory Direct - 877-452-0157	8	California - All Counties not covered by Richard. Nevada - All Counties except Clark County. Call Factory Direct - 877-452-0157
3	Call Factory Direct - 877-452-0157	9	Call Factory Direct - 877-452-0157
4	Andy Kromer Cell: 440-364-4721 Email: aklub@lubricationscientifics.com	10	Call Factory Direct - 877-452-0157
5	Call Factory Direct - 877-452-0157		
6	Cory Walker Cell: 832-585-7065 Email: c.walker@lubricationscientifics.com		

Outside of the United States	Call Factory Direct - 877-452-0157
------------------------------	------------------------------------

Customer Service (877-452-0157)

- ◆ Order status & order entry
- ◆ Pricing inquiries
- ◆ Part number look-ups
- ◆ Product availability information
- ◆ Shipment assistance
- ◆ All other general inquires

www.lubricationsscintifics.com

- ◆ Product information, specifications, literature
- ◆ Locate sales reps and distributors
- ◆ Operator & Repair manuals
- ◆ Distributer Information
- ◆ Place orders and check current pricing
- ◆ Product Pricing

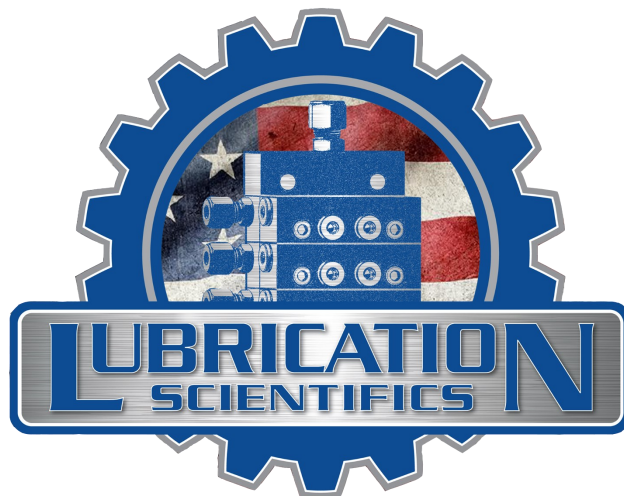

LUBRICATION SCIENTIFICS, LLC

17651 ARMSTRONG AVE.

IRVINE, CA 92614

UNITED STATES OF AMERICA

TOLL FREE TEL: (877) 452-0157, LOCAL TEL: (714) 557-0664, FAX: (714) 546-4564

WWW.LUBRICATIONSCIENTIFICS.COM