

LUBRICATION SCIENTIFICS, LLC

THE RIGHT PRODUCTS. THE RIGHT VALUES. THE RIGHT CHOICE.

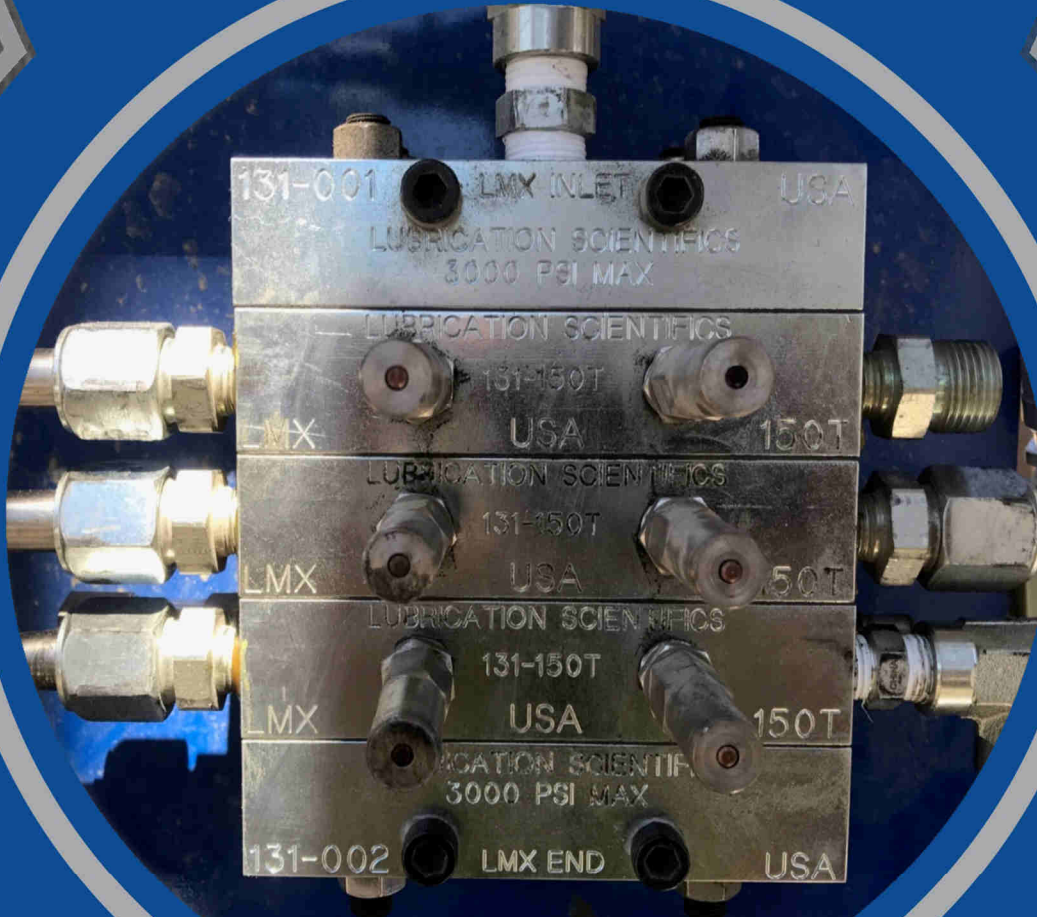

LMX SERIES PROGRESSIVE DIVIDER VALVE SYSTEMS

MEDIUM OUTPUT VALVES—CRITICAL MONITORING—ACCESSORIES



LMX SERIES—HIGH OUTPUT, SERIES PROGRESSIVE, TRADITIONAL DIVIDER VALVES

PRODUCT DESCRIPTION

HEAVY DUTY, HIGH OUTPUT, SERIES PROGRESSIVE
DIVIDER VALVE

CARBON STEEL CONSTRUCTION, STAINLESS STEEL
AVAILABLE BY SPECIAL ORDER

LARGE FOOTPRINT, STANDARD PRESSURE, 3000 PSI

ROHS COMPLIANT CLEAR ZINC PLATING

STAINLESS STEEL CAPS AND MOUNTING BOLTS
INCLUDED

GASKETS SUPPLIED WITH EACH VALVE AND END
SECTION

BENEFITS & FEATURES

TRADITIONAL HIGH OUTPUT DIVIDER VALVE

CARBON STEEL CONSTRUCTION
(316 STAINLESS STEEL UPON SPECIAL ORDER)

CAN ACCOMMODATE PRESSURES UP TO 3000
PSI

USE FOR HEAVY INDUSTRY APPLICATIONS

INTERNAL 316 STAINLESS STEEL OUTLET CHECK
VALVES

DESIGNED FOR OIL AND GREASE

CAN LUBRICATE 1 TO 20 LUBE POINTS

PRECISE LUBRICANT FLOW TO LUBE POINTS

READY FOR IMMEDIATE SHIPMENT

MADE IN



WWW.LUBRICATIONSCIENTIFICS.COM

FUNCTION ILLUSTRATION & SPECIFICATIONS

PRECISE LUBRICATION IS ESSENTIAL FOR PROPER MECHANICAL PERFORMANCE. PUMPS PROVIDE MEASURED PRESSURIZED LUBRICATION TO MASTER VALVE. MASTER VALVE DISTRIBUTES A MEASURED AMOUNT OF LUBRICATION TO CORRESPONDING SECONDARY VALVES. SECONDARY VALVES DISTRIBUTE MEASURED LUBRICATION TO VARIOUS LUBE POINTS IN SYSTEM.

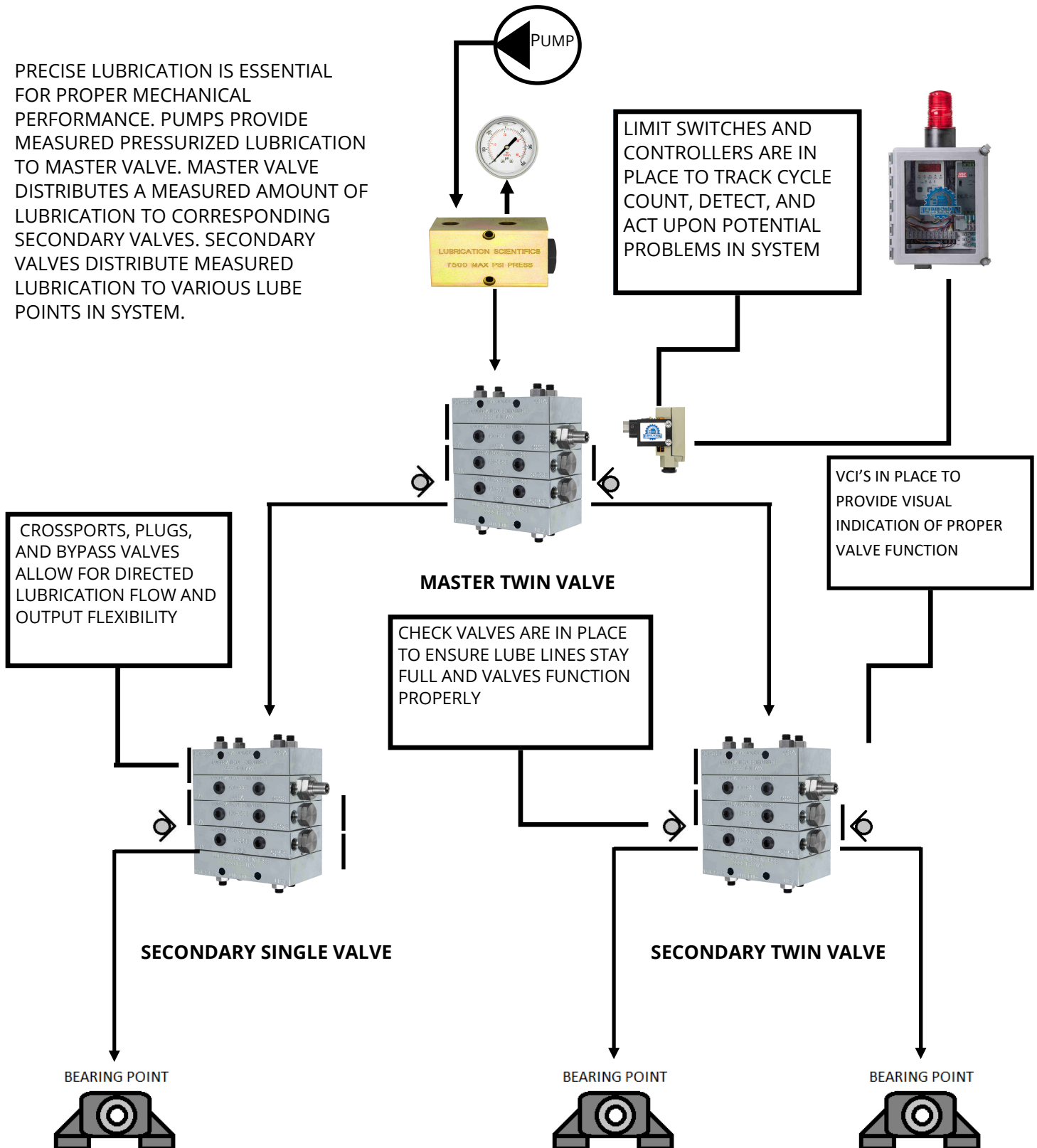

ORDERING INFORMATION & PART NUMBERS

CARBON STEEL DIVIDER VALVES

STAINLESS STEEL VALVES AVAILABLE BY SPECIAL ORDER

STANDARD PACK: 1 EACH			
SINGLE OUTPUT		TWIN OUTPUT	
OUTPUT PER CYCLE	PART NUMBER	OUTPUT PER CYCLE	PART NUMBER
.050 CI .820 CC	131-025S	.025 CI .410 CC	131-025T
.100 CI 1.639 CC	131-050S	.050 CI .820 CC	131-050T
.150 CI 2.459 CC	131-075S	.075 CI 1.230 CC	131-075T
.200 CI 3.278 CC	131-100S	.100 CI 1.639 CC	131-100T
.250 CI 4.098 CC	131-125S	.125 CI 2.049 CC	131-125T
.300 CI 4.917 CC	131-150S	.150 CI 2.459 CC	131-150T

SUPPLIED WITH GASKET

ADD SUFFIX -RHICIP TO VALVE PART NUMBER TO ADD RIGHT HAND CYCLE INDICATOR PIN

CARBON STEEL MANIFOLD COMPONENTS

STANDARD PACK: 1 EACH	
PART DESCRIPTION	PART NUMBER
INLET—3/8-18 NPSF INLET PORT	131-INL-US
INLET—3/4-16 SAE INLET PORT	131-INL-SAE
END (ALL)	131-END

SUPPLIED WITH GASKET

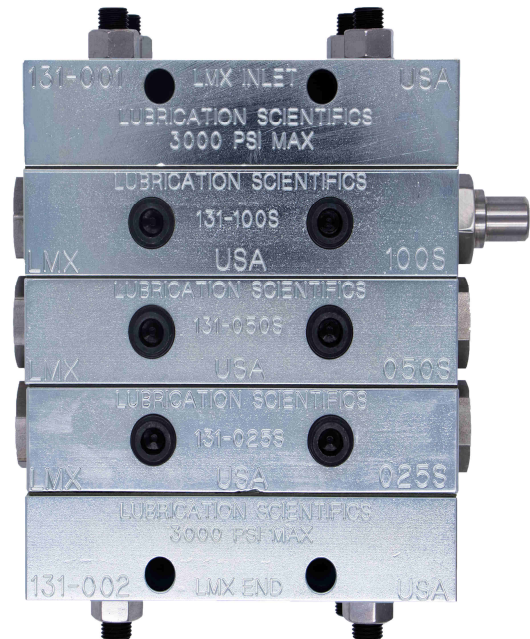

ORDERING INFORMATION & PART NUMBERS

TIE RODS—REQUIRED FOR STEEL VALVES 4 TIE RODS REQUIRED PER VALVE ASSEMBLY



STANDARD PACK: 4 EACH	
PART DESCRIPTION	PART NUMBER
3 SECTION VALVE ASSEMBLY	131-TR3
4 SECTION VALVE ASSEMBLY	131-TR4
5 SECTION VALVE ASSEMBLY	131-TR5
6 SECTION VALVE ASSEMBLY	131-TR6
7 SECTION VALVE ASSEMBLY	131-TR7
8 SECTION VALVE ASSEMBLY	131-TR8
9 SECTION VALVE ASSEMBLY	131-TR9
10 SECTION VALVE ASSEMBLY	131-TR10

FRONT CROSSPORT KITS

STANDARD PACK: 1 EACH	
PART DESCRIPTION	PART NUMBER
2 VALVES, 1 OUTPUT	131-303-413
3 VALVES, 1 OUTPUT	131-303-414
4 VALVES, 1 OUTPUT	131-303-415

REPLACEMENT CLOSURE PLUGS & GASKETS

STANDARD PACK: 10 EACH	
PART DESCRIPTION	PART NUMBER
OUTLET PLUG, 1/4-18 NPTF	A-250-A
PISTON BORE CLOSURE PLUG WITH VITON O-RINGS	132-A-001-303
GASKET—ALL VALVES/INTERMEDIATES, ENDS	131-GSK

ORDERING INFORMATION & PART NUMBERS

ADDITIONAL ACCESSORIES FOR LUBE SYSTEM INSTALLATIONS

RESET INDICATORS COME STANDARD WITH 1/8" THREAD. LMX PORTS ARE 1/4" THREAD, ADAPTER IS REQUIRED FOR EACH RESET INDICATOR FOR THE SERIES VALVE.

CHECK VALVES—OCV SERIES

OUTLET TYPE WITH SINGLE BALL CHECK VALVES

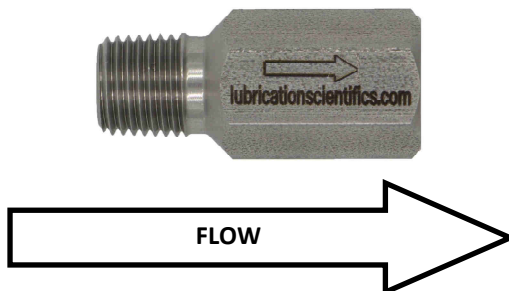

STANDARD PACK: 5 EACH					
CHECK VALVE DESCRIPTION			PART NUMBER		
INLET SIZE	OUTLET SIZE	BALL OPEN PSI / BAR	303 STAINLESS	316 STAINLESS	ADAPTER REQUIREMENTS
1/4"NPTF (M)	1/4" NPSF (F)	35 / 2.41	OCV-303-250R-35	OCV-316-250R-35	TUBE FITTING

PERFORMANCE RESET INDICATORS W/ MEMORY

STANDARD PACK: 5 EACH	1/8 NPSF O-RING CONNECTION	
	303 STAINLESS	316 STAINLESS
ITEM DESCRIPTION		
1,000 PSI 69 BAR	303-P1000	316-P1000
1,500 PSI 103 BAR	303-P1500	316-P1500
2,000 PSI 138 BAR	303-P2000	316-P2000
2,500 PSI 172 BAR	303-P2500	316-P2500
3,000 PSI 207 BAR	303-P3000	316-P3000
3,500 PSI 241 BAR	303-P3500	316-P3500
5,000 PSI 345 BAR	303-P5000	316-P5000
LINCOLN® STYLE INDICATOR ADAPTER	303-PI-ADP-L	316-PI-ADP-L



NOTE: PERFORMANCE INDICATORS ARE COMPATIBLE WITH TRABON® STYLE DIVIDER VALVES ONLY

ORDERING INFORMATION & PART NUMBERS
ADDITIONAL ACCESSORIES FOR LUBE SYSTEM INSTALLATIONS

PROXIMITY SWITCHES

STANDARD PACK: 1 EACH				
ITEM DESCRIPTION	VALVE ADAPTER	PART NUMBER	MAX PSI	HAZARD RATING
PROXIMITY SWITCH, 3 PIN MINI-QUICK DISCONNECT	LMX/LMXP	L527251-1312	7,500 PSI 517 BAR	NOT RATED
PROXIMITY SWITCH, 4 PIN MINI-QUICK DISCONNECT	LMX/LMXP	L527112-1312	7,500 PSI 517 BAR	NOT RATED
PROXIMITY SWITCH, 5 PIN MINI-QUICK DISCONNECT	LMX/LMXP	L527111-1312	7,500 PSI 517 BAR	NOT RATED
PROXIMITY SWITCH, EXPLOSION PROOF, 1/2" NPT WITH LEADS	LMX/LMXP	L527431-1312	7,500 PSI 517 BAR	CLASS I, GROUPS A,B,C,D CLASS II, GROUPS E,F,G CLASS III

PROXIMITY CABLES

STANDARD PACK: 1 CABLE	
ITEM DESCRIPTION	12' CABLE PART NUMBER
12' 3 PIN CABLE	L527251-CBL12
12' 4 PIN CABLE	L527112-CBL12
12' 5 PIN CABLE	L527111-CBL12

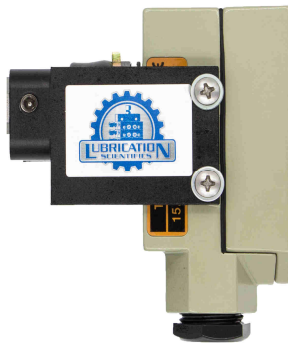
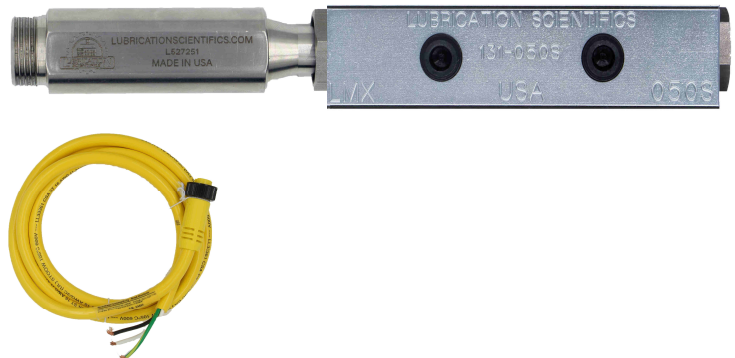

CYCLE VERIFICATION DEVICES

STANDARD PACK: 1 EACH	
ITEM DESCRIPTION	PART NUMBER
STAINLESS STEEL VISUAL CYCLE INDICATOR	VCI-437-1312



LIMIT SWITCHES

STANDARD PACK: 1 EACH	
ITEM DESCRIPTION	PART NUMBER
LIMIT SWITCH ASSEMBLY, SPDT	LSW-001
LIMIT SWITCH ASSEMBLY, DPDT	LSW-002

ORDERING INFORMATION & PART NUMBERS

ADDITIONAL ACCESSORIES FOR VERIFYING LUBRICATION SYSTEM FUNCTION

CONTAMINATION IS THE ENEMY OF RELIABILITY

THE DIRT TRAP IS THE ANSWER

DIRT TRAP FILTER



STANDARD PACK: 1 EACH	
FILTER RATING	PLATED CARBON STEEL 7,500 PSI / 517 BAR
5 MICRON	DTFA-005-O
10 MICRON	DTFA-010-O
25 MICRON	DTFA-025-O
150 MICRON 100 MESH	DTFA-100-G
420 MICRON 40 MESH	DTFA-040-G

DIRT TRAP REPLACEMENT ELEMENT

STANDARD PACK: 1 EACH	
FILTER RATING	PART NUMBER
5 MICRON	DT-EL-002-005MIC
10 MICRON	DT-EL-002-010MIC
25 MICRON	DT-EL-002-025MIC
150 MICRON 100 MESH	DT-EL-002-100M
420 MICRON 40 MESH	DT-EL-002-40M



NOTE: REPLACEMENT ELEMENTS ARE COMPATIBLE WITH BOTH THE CARBON STEEL AND 2024 ALUMINUM MODELS.

ORDERING INFORMATION & PART NUMBERS
ADDITIONAL ACCESSORIES FOR LUBE SYSTEM INSTALLATIONS

ANCHOR BLOCKS

STANDARD PACK: 5 EACH			
PRODUCT DESCRIPTION	CARBON STEEL	303 STAINLESS STEEL	316 STAINLESS STEEL
4 WAY CROSS 1/8 NPSF (X4) 9/32 MTG HOLE	L509189-000	L509189-303	L509189-316
4 WAY CROSS 1/4 NPSF (X4) 9/32 MTG HOLE	L509188-000	L509188-303	L509188-316
5 WAY CROSS 1/4 NPSF (X4) 1/8 NPSF (X1) 9/32 MTG HOLE	L509190-000	L509190-303	L509190-316
2 WAY STRAIGHT 1/8 NPSF (X2) 9/32 MTG HOLE	L509180-000	L509180-303	L509180-316
2 WAY STRAIGHT 1/4 NPSF (X2) 9/32 MTG HOLE	L509185-000	L509185-303	L509185-316
90 DEGREE ELBOW 1/8 NPSF (X2) 9/32 MTG HOLE	L509170-000	L509170-303	L509170-316
90 DEGREE ELBOW 1/4 NPSF (X2) 9/32 MTG HOLE	L509175-000	L509175-303	L509175-316



LMX FEEDER PART NUMBER ORDERING GUIDE

LMX-XXX-XXXXXX

LMX- XXX -XXXXXX	
INSTALLED ACCESSORIES	P/N
NO INTERNAL CHECK VALVES	X
EXTERNAL CHECK VALVES	C
PERFORMANCE INDICATORS	P
PERFORMANCE INDICATORS & CHECK VALVES	B

LMX- XXX -XXXXXX	
NUMBER OF SECTIONS	P/N
THREE	3
FOUR	4
FIVE	5
SIX	6
SEVEN	7
EIGHT	8
NINE	9
TEN	10

LMX-XXX- XXXX XX	
VALVE SIZE	P/N
BYPASS SECTION	BP
.025 CU. IN.	25
.050 CU. IN.	50
.075 CU. IN.	75
.100 CU. IN.	100
.125 CU. IN.	125
.150 CU. IN.	150

*LINCOLN® IS A REGISTERED TRADEMARK OF LINCOLN® INDUSTRIAL
 GRACO® IS A REGISTERED TRADEMARK OF GRACO®
 TRABON® IS A REGISTERED TRADEMARK OF GRACO®
 FARVAL® IS A REGISTERED TRADEMARK OF BIJUR DELIMON INTERNATIONAL

LMX-XXX- XXXX XX	
TYPE OF SECTION	P/N
TWIN	T
SINGLE, RH OUTLET	S
SINGLE, LH OUTLET	L
TWIN, CIP RIGHT	B
SINGLE, CIP RIGHT, RH OUTLET	C
SINGLE, CIP RIGHT, LH OUTLET	D
TWIN, PROXIMITY SWITCH RIGHT	E
SINGLE, PROXIMITY SWITCH RIGHT, RH OUTLET	F
SINGLE, PROXIMITY SWITCH RIGHT, LH OUTLET	G
TWIN, CIP LEFT	H
SINGLE, CIP LEFT, RH OUTLET	J
SINGLE, CIP LEFT, LH OUTLET	K
TWIN, PROXIMITY SWITCH LEFT	M
SINGLE, PROXIMITY SWITCH LEFT, RH OUTLET	N
SINGLE, PROXIMITY SWITCH LEFT, LH OUTLET	P

LMX-XXX- XXXX XX	
CROSSPORT OPTION	P/N
RIGHT SIDE	CR
LEFT SIDE	CL
BOTH SIDES	CB

MOUNTING INFORMATION & SPECIFICATIONS

NUMBER OF SECTIONS	DIMENSION A		DIMENSION B		DIMENSION C	
	inch	mm	inch	mm	inch	mm
3	4.938	125.43	5.500	139.70	6.625	168.27
4	6.038	153.37	6.600	167.64	7.750	196.85
5	7.138	181.31	7.700	195.58	8.875	225.42
6	8.238	209.25	8.800	223.52	10.000	254.00
7	9.338	237.19	9.900	251.46	11.125	282.57
8	10.438	265.13	11.000	279.4	12.250	311.15
9	11.538	293.07	12.100	307.34	13.375	339.72
10	12.638	321.01	13.100	332.74	14.500	368.30

SPECIFICATIONS

MATERIAL: ZINC PLATED STEEL, SS316

MAX CYCLE RATE (OIL) 60 CPM

MAX PRESSURE: 3000 PSI

APPLICATION: OIL & GREASE

TORQUE SPECIFICATIONS

TIE ROD NUT: 30 FT/LBS

VALVE MOUNTING BOLTS: 12-13 FT/LBS

ALT. OUTLET PORTS: 8-9 FT/LBS

PISTON CLOSURE PORT: 22-24 FT/LBS

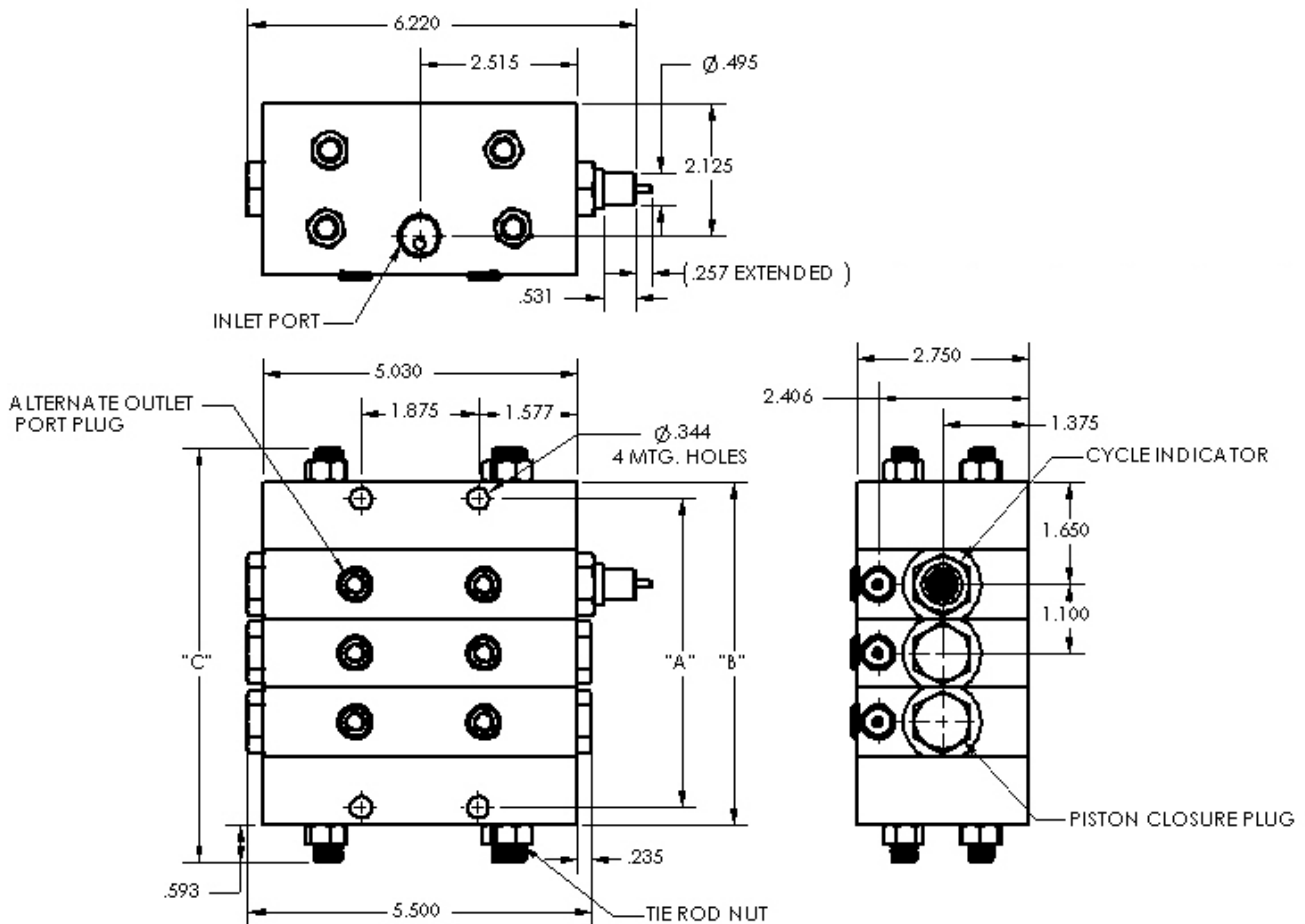

CONTACT US

IN THE USA, FIND YOUR STATE IN THE MAP BELOW, LOOK FOR THE REGION ID NUMBER AND FIND THAT NUMBER IN THE CONTACT INFORMATION CHART.



1	Call Factory Direct - 877-452-0157	7	Richard Hanley - California - Santa Barbara, Ventura, Los Angeles, Orange, San Bernardino, Riverside, San Diego and Imperial Counties. Nevada - Clark County. Cell: 714-625-5539 Email: rth@lubricationscientifics.com
2	Call Factory Direct - 877-452-0157	8	California - All Counties not covered by Richard. Nevada - All Counties except Clark County. Call Factory Direct - 877-452-0157
3	Call Factory Direct - 877-452-0157	9	Call Factory Direct - 877-452-0157
4	Andy Kromer Cell: 440-364-4721 Email: aklub@lubricationscientifics.com	10	Call Factory Direct - 877-452-0157
5	Call Factory Direct - 877-452-0157		
6	Cory Walker Cell: 832-585-7065 Email: c.walker@lubricationscientifics.com		

Outside of the United States	Call Factory Direct - 877-452-0157
------------------------------	------------------------------------

Customer Service (877-452-0157)

- ◆ Order status & order entry
- ◆ Pricing inquiries
- ◆ Part number look-ups
- ◆ Product availability information
- ◆ Shipment assistance
- ◆ All other general inquires

www.lubricationscientifics.com

- ◆ Product information, specifications, literature
- ◆ Locate sales reps and distributors
- ◆ Operator & Repair manuals
- ◆ Distributer Information
- ◆ Place orders and check current pricing
- ◆ Product Pricing

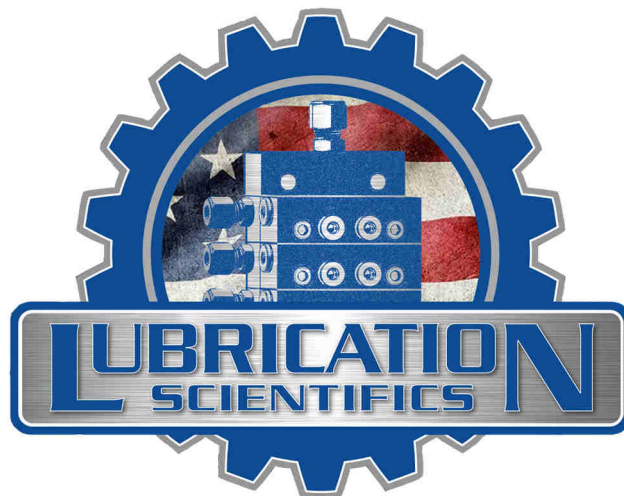

LUBRICATION SCIENTIFICS, LLC

17651 ARMSTRONG AVE.

IRVINE, CA 92614

UNITED STATES OF AMERICA

TOLL FREE TEL: (877) 452-0157, LOCAL TEL: (714) 557-0664, FAX: (714) 546-4564

WWW.LUBRICATIONSCIENTIFICS.COM